

2:PROJECT/PRJ2020PRJ300073/CONCEN-1181/HIGHWAY 27, JONHART, NICHOLAS/HEBERT/SIGNAGE EXHIBIT/2020-04-24, SIGNAGE EXHIBIT, JONHART, NJ 08542

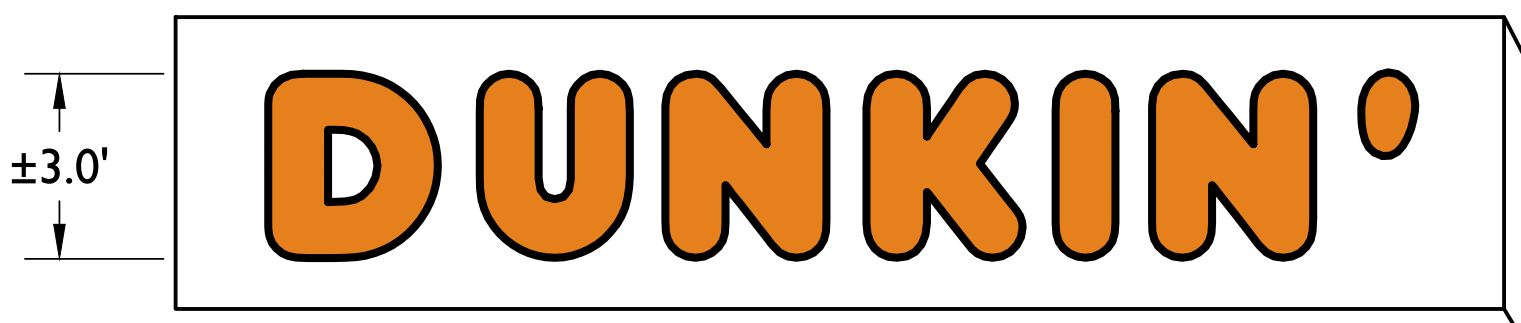

S3 LOGO WALL SIGN: 12 SF



S2 'DUNKIN'' WALL SIGN: 25 SF

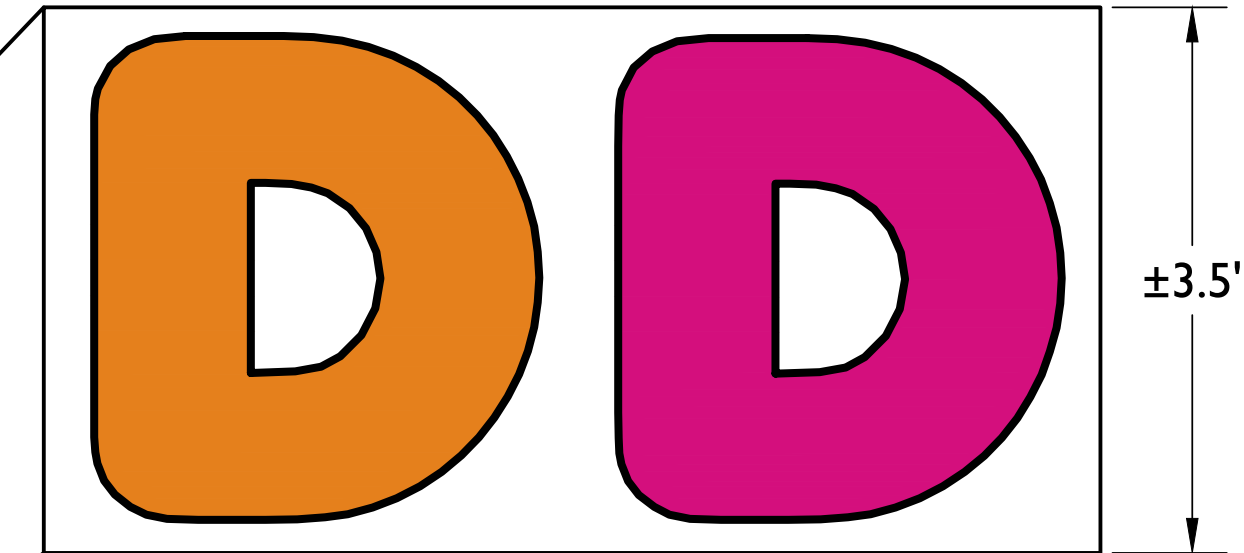

S1 'DD' WALL SIGN: 18 SF



S2 'DUNKIN'' WALL SIGN: 25 SF

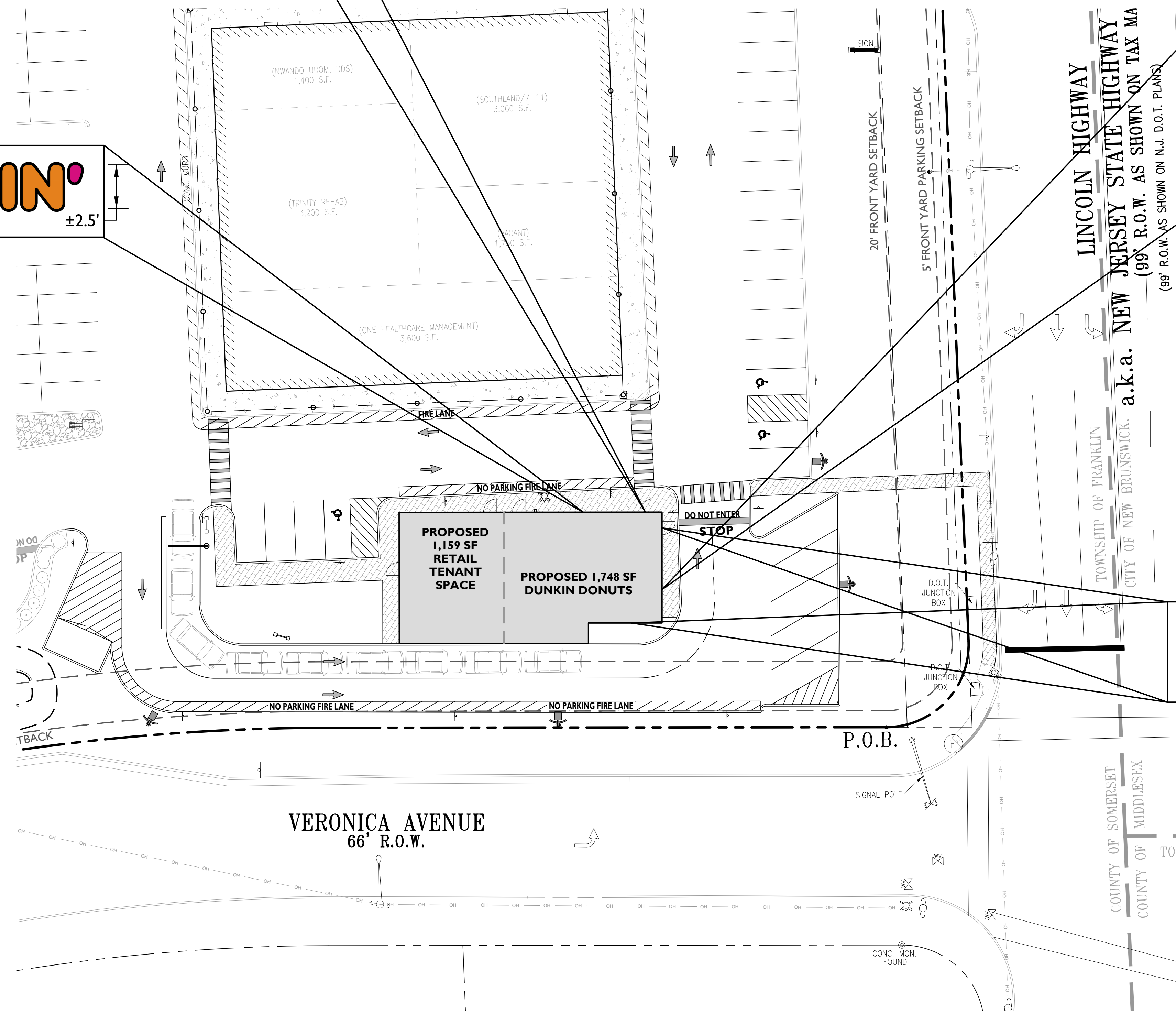

PROPOSED SIGNAGE SUMMARY	
NAME	AREA
S1 'DD' WALL SIGN EAST FACADE	18 SF
S2 'DUNKIN'' WALL SIGN EAST, NORTH, AND SOUTHWEST FACADE	25 SF
S3 LOGO WALL SIGN NORTH FACADE	12 SF

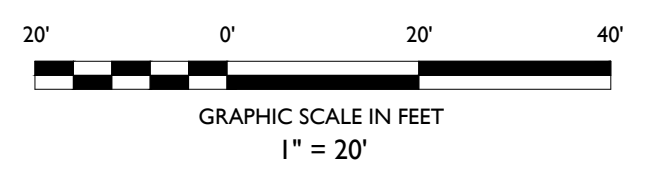

ISSUE	DATE	BY	DESCRIPTION
1	01/27/2021	AMB	FOR TOWNSHIP SUBMISSION
1	09/24/2020	CJS	FOR TOWNSHIP SUBMISSION

NOT APPROVED FOR CONSTRUCTION

STONEFIELD
engineering & design

Rutherford, NJ · New York, NY · Boston, MA
Princeton, NJ · Tampa, FL · Detroit, MI
www.stonefielddesign.com
15 Spring Street, Princeton, NJ 08542
Phone 609.362.6900

PROPOSED SIGNAGE EXHIBIT

3 RONSON, LLC
NIDOT APPLICATION # A-27-C-2396-2020
115 EAST 11TH AVENUE
ROSELLE, NJ 07203

PROPOSED FAST FOOD RESTAURANT AND RETAIL TENANT
BLOCK 88.0, LOT 43
1165 NJ STATE ROUTE 27
TOWNSHIP OF FRANKLIN
SOMERSET COUNTY, NEW JERSEY

JEFFREY A. MARTELL, P.E.
NEW JERSEY LICENSE No. 47290
LICENSED PROFESSIONAL ENGINEER

STONEFIELD
engineering & design

SCALE: 1" = 20' PROJ. ID: PRI-200007

TITLE:
PROPOSED SIGNAGE EXHIBIT

DRAWING:
I OF I