

CURRENT PROPOSED LAYOUT

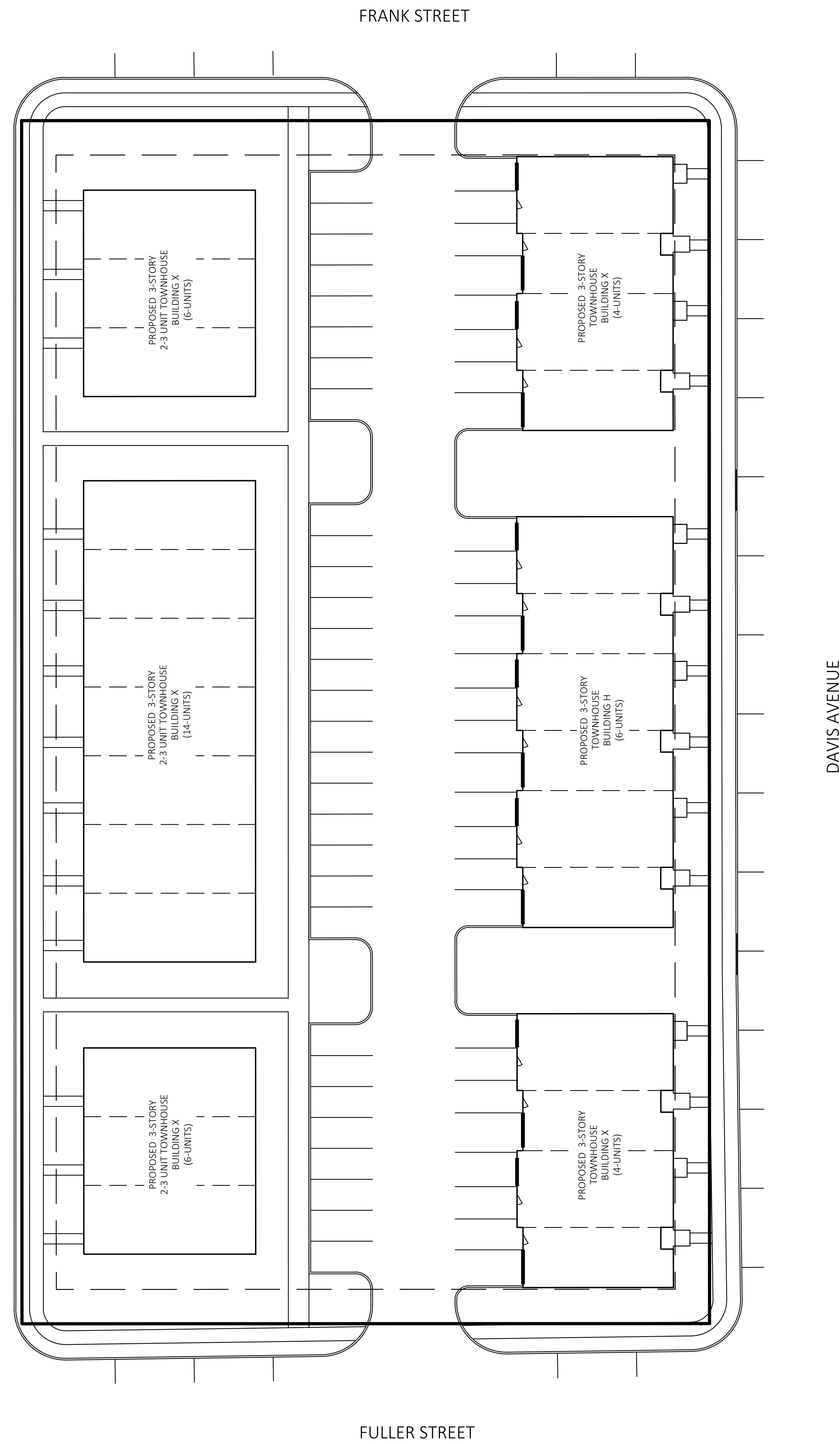

FULL BUILD-OUT LAYOUT

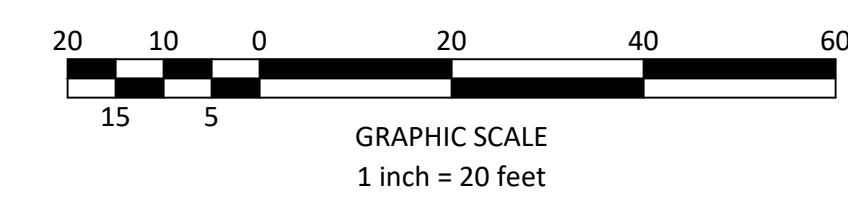

DATE	REVISIONS	BY

**SHORE POINT ENGINEERING**  
 Certificate of Authorization No. 24GA28317800  
 Kevin E. Shelly P.E. PE No. GE05051300  
 PO Box 257, Monroeville, NJ 08765  
 T: 732-924-8100 | F: 732-924-8110  
 www.shorepointengineering.com

Kevin E. Shelly, P.E.  
 PROFESSIONAL ENGINEER  
 N.J. Lic. No. CE05051300

**PRELIMINARY/FINAL MAJOR SITE PLAN  
 FRANKLIN TOWNHOMES  
 BLOCK 132**

SITUATED IN  
 TOWNSHIP OF FRANKLIN, SOMERSET COUNTY, NEW JERSEY

**BLOCK 132 BUILD-OUT**

SCALE: 1"=20'	PROJECT No.: RPM-191
RELEASED BY: KES	DATE: 10/14/21
CHECKED BY: KES	Sheet Number
DRAWN BY: KES	<b>1 OF 1</b>

File Name: C:\Users\jwheeler\OneDrive - Shore Point Engineering\Shore Point Engineering\Clients\RPM Development\Jobs\RPM-191 - Franklin Townhomes - Franklin ( Somerset)\DWG\19-LAYOUT - AT.CAD  
 Date: 10/14/21 11:52:00 AM