

OUTLET CONTROL STRUCTURE DETAIL (BASIN A)

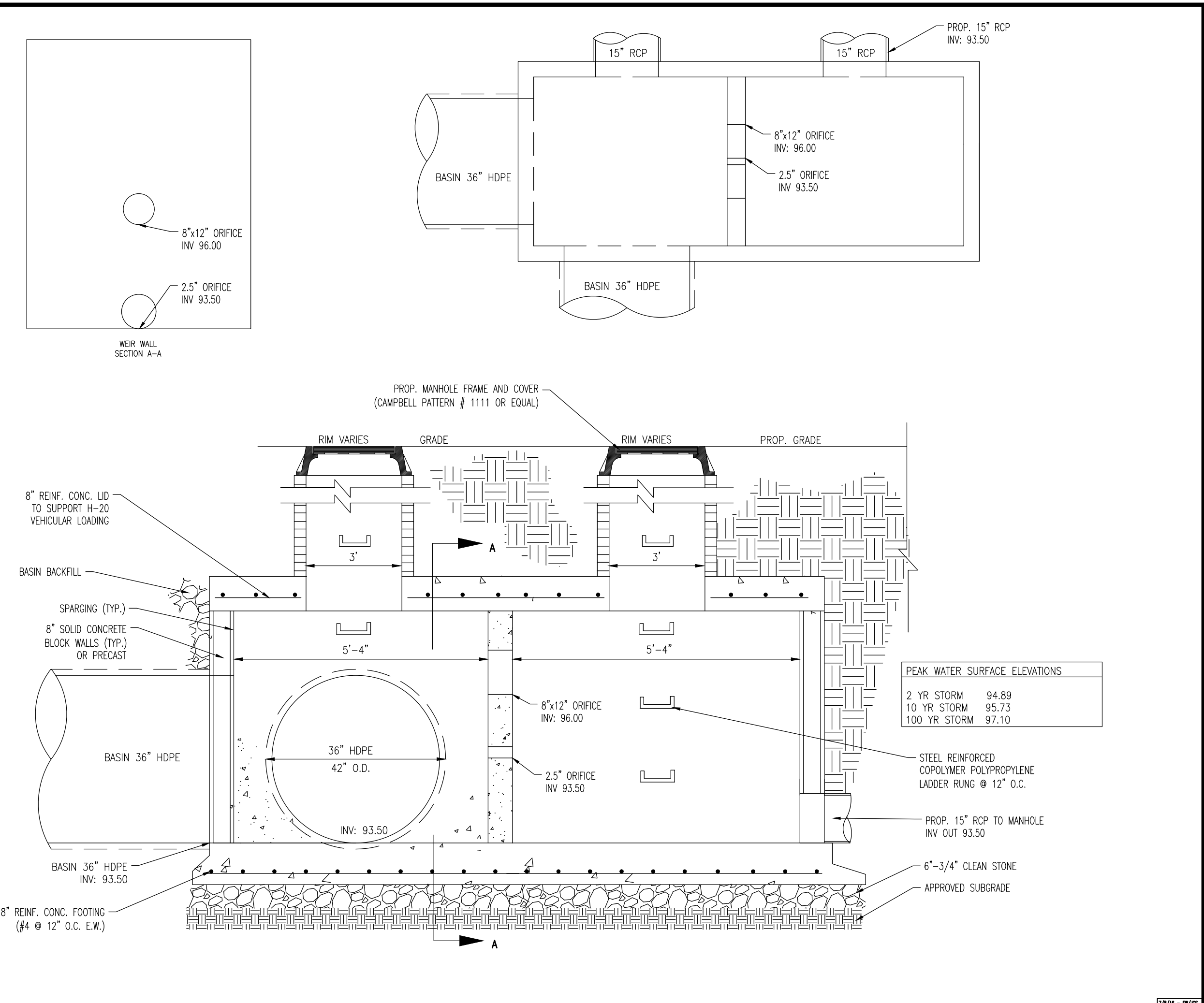

OUTLET STRUCTURE DETAIL (BASIN B)

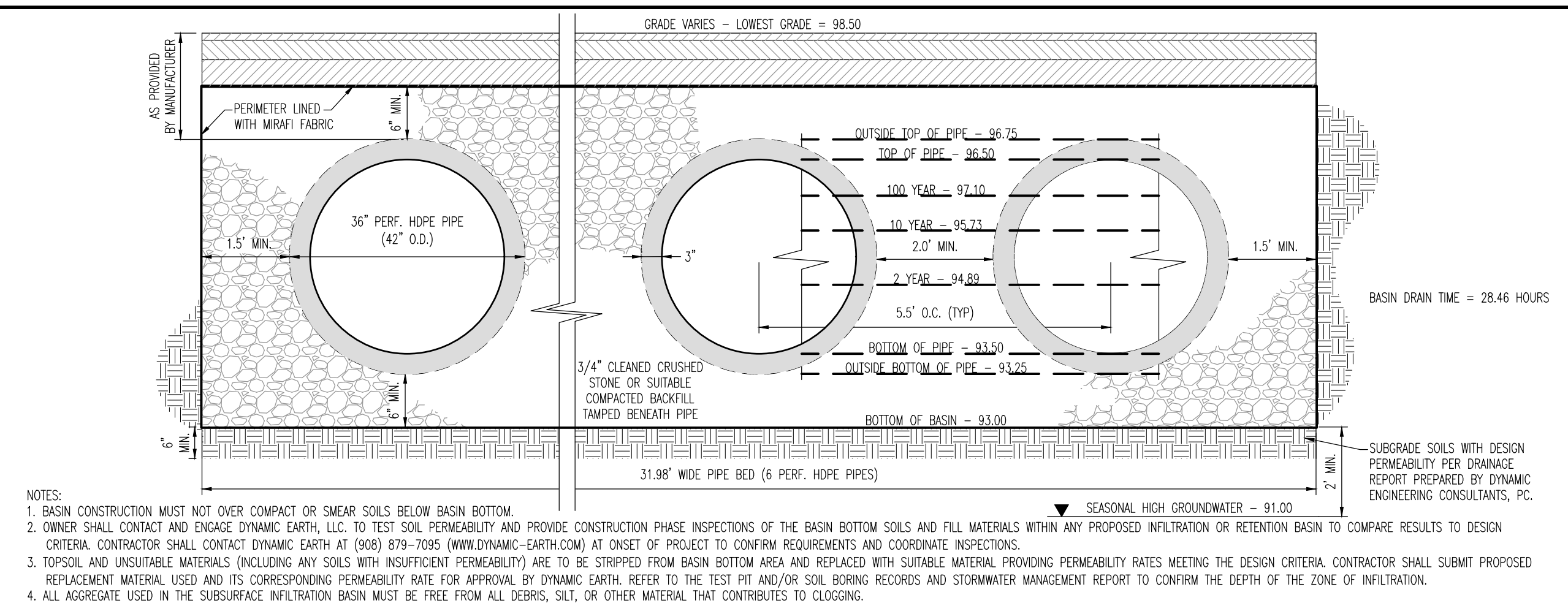

36" HDPE SCHEMATIC UNDERGROUND BASIN DETAIL

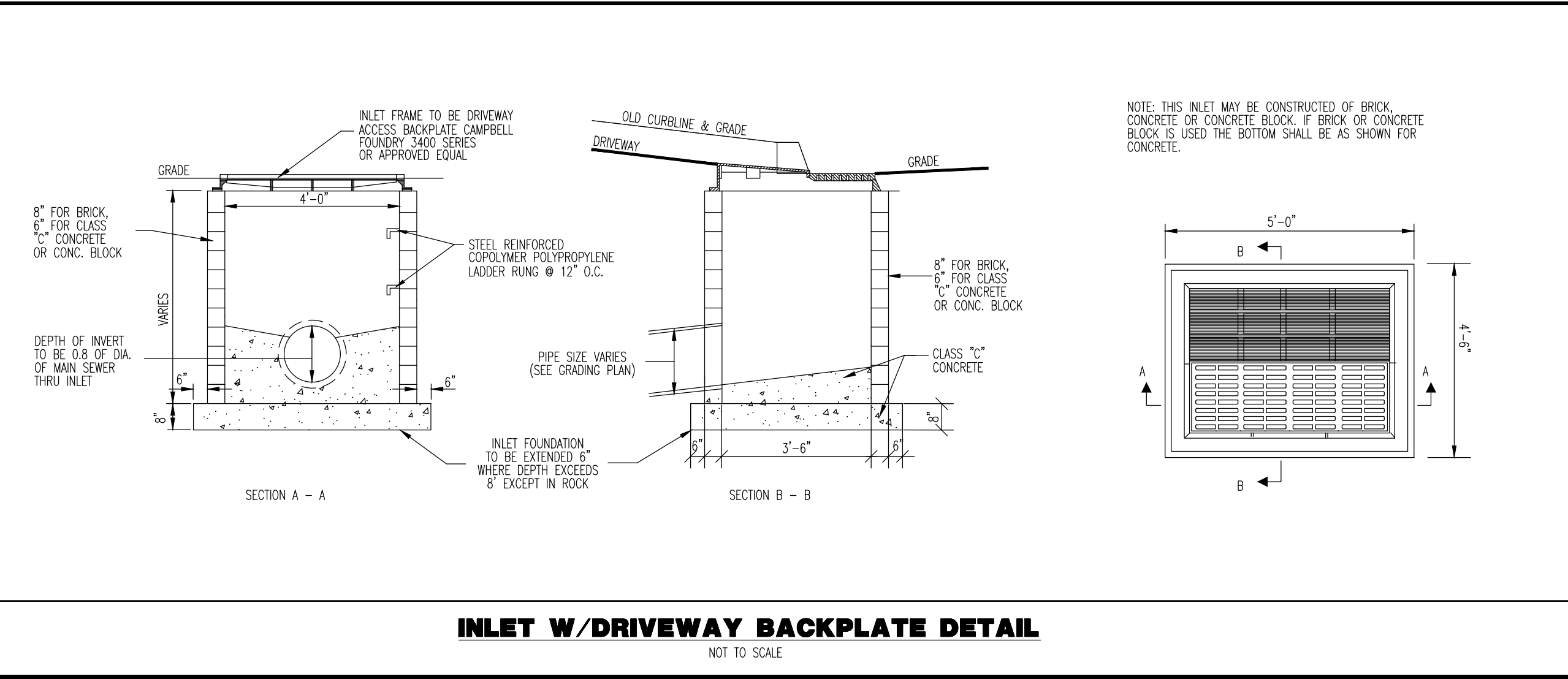

INLET W/DRIVEWAY BACKPLATE DETAIL

IN CASE OF DISCREPANCY, TOWNSHIP STANDARD DETAILS SHALL HOLD

THIS PLAN SET IS FOR PERMITTING PURPOSES ONLY AND MAY NOT BE USED FOR CONSTRUCTION

DYNAMIC ENGINEERING
 LAND DEVELOPMENT CONSULTING • PERMITTING • GEOTECHNICAL • ENVIRONMENTAL • SURVEY • PLANNING & ZONING

1904 Main Street
 Lake Como, NJ 07719
 T: 732.974.0198
 F: 732.974.3521
 www.dynamiceng.com

1504 Main Street
 Lake Como, NJ 07719
 T: 732.974.0198
 F: 732.974.3521
 www.dynamiceng.com

TITLE: **CONSTRUCTION DETAILS**

PROJECT: **BH 31 SCHOOLHOUSE ROAD LLC PROPOSED WAREHOUSE**

BLOCK: 517.04 LOT: 21.03
 31 SCHOOLHOUSE ROAD
 TOWNSHIP OF FRANKLIN, SOMERSET COUNTY, NEW JERSEY

JOB No: 2906-99-003 DATE: 03/03/2022

DRAWN BY: NSR SCALE: (H) NOT TO (V) SCALE

DESIGNED BY: AG SHEET No:

CHECKED BY: KCK

CHECKED BY: -

KYLE C. KAVINSKI **JOSHUA M. SEWALD**

PROFESSIONAL ENGINEER NEW JERSEY LICENSE No. 52985

PROFESSIONAL ENGINEER NEW JERSEY LICENSE No. 52908

16
OF 24

Rev. # 1

Plotted: 07/19/22 - 4:30 PM, By: kheese, Product Ver: 24.0a (LMS Tech)
 File: P:\BCCP PROJECTS\2906 Duck River Textile\98-003 Franklin\DWG\Site Plans\0290699003SD1.dwg, ---> 16 CONSTRUCTION DETAILS

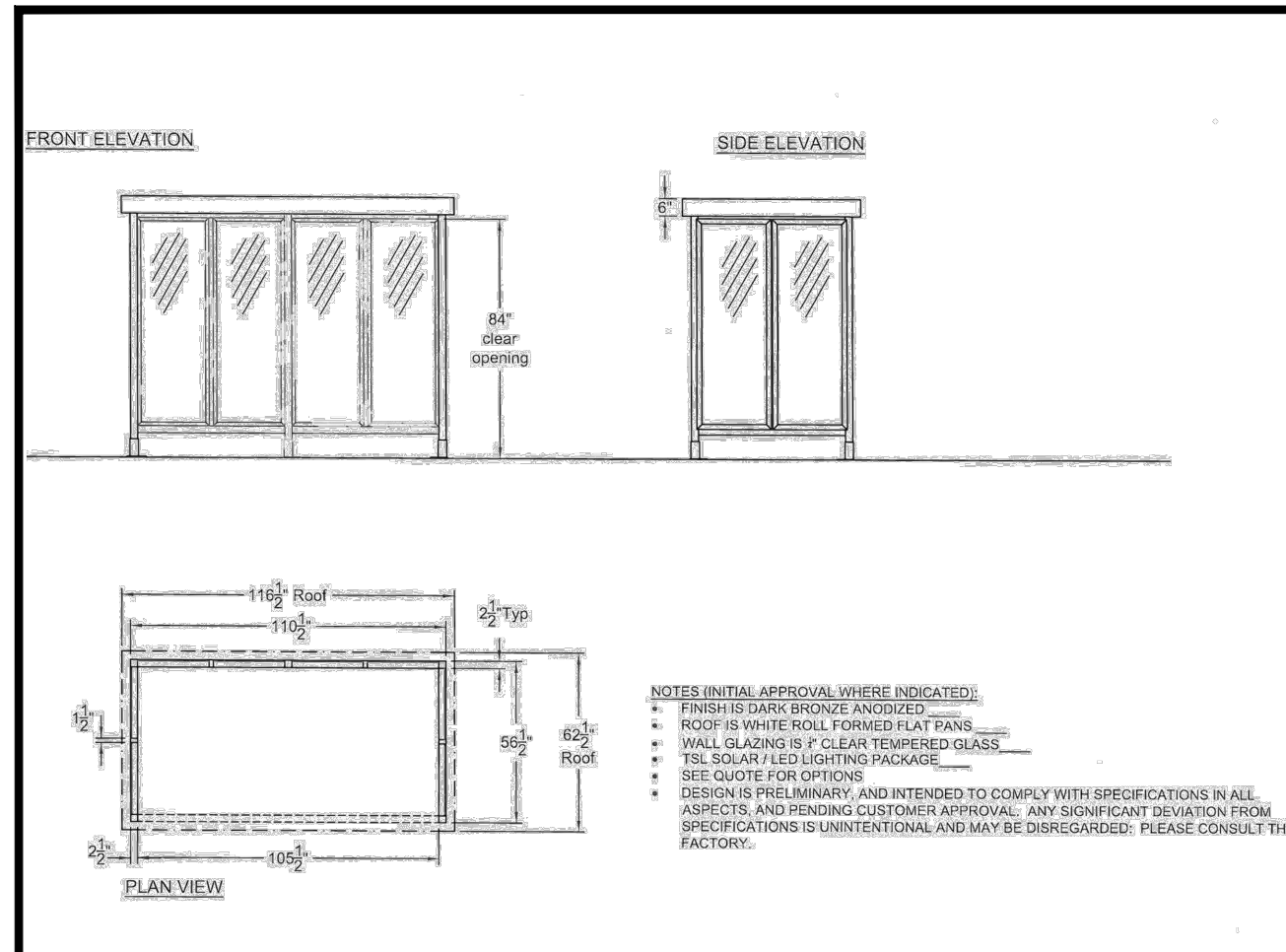

SHELTER DETAIL

NOT TO SCALE

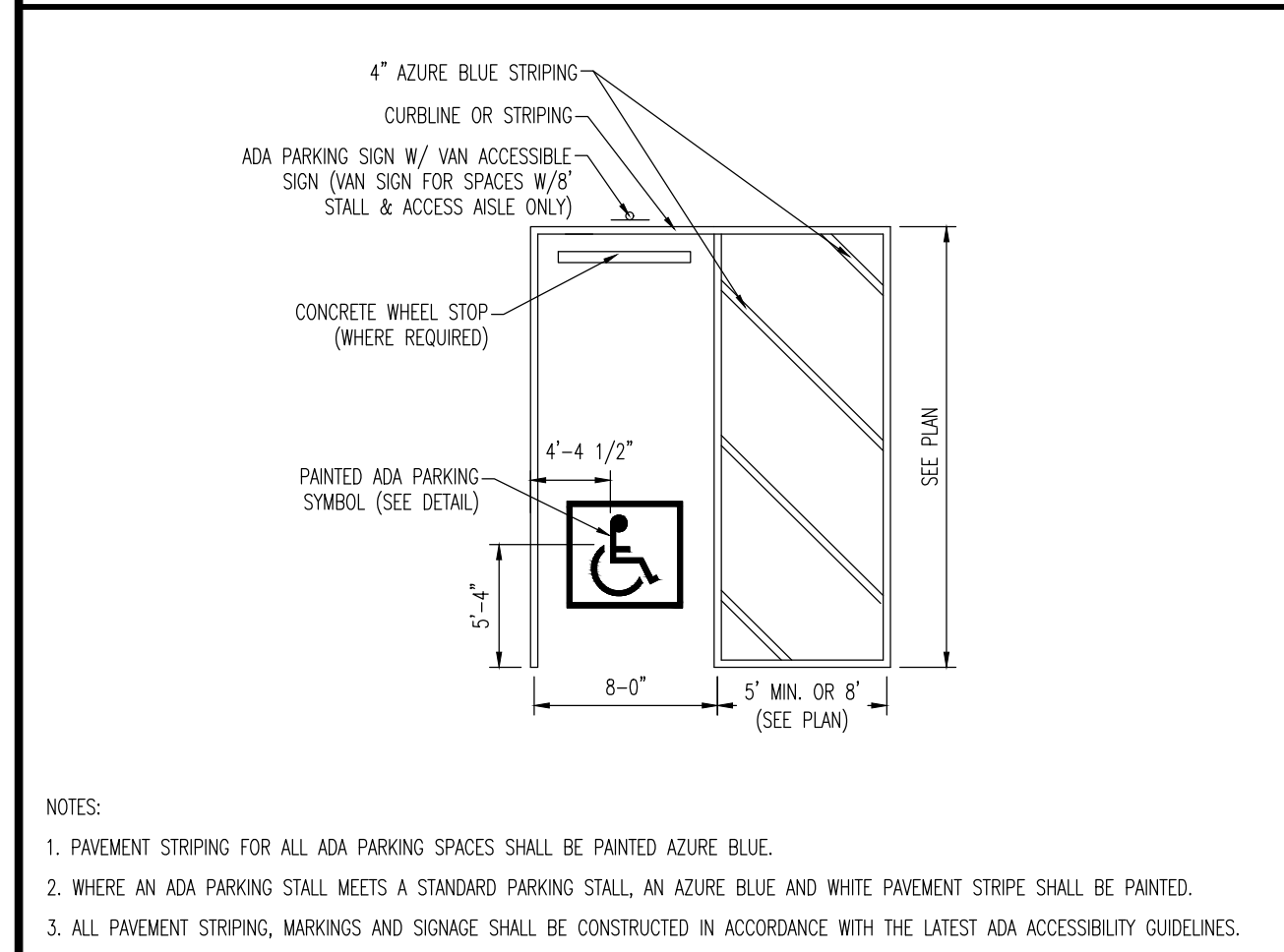

ADA STALL MARKINGS DETAIL

NOT TO SCALE

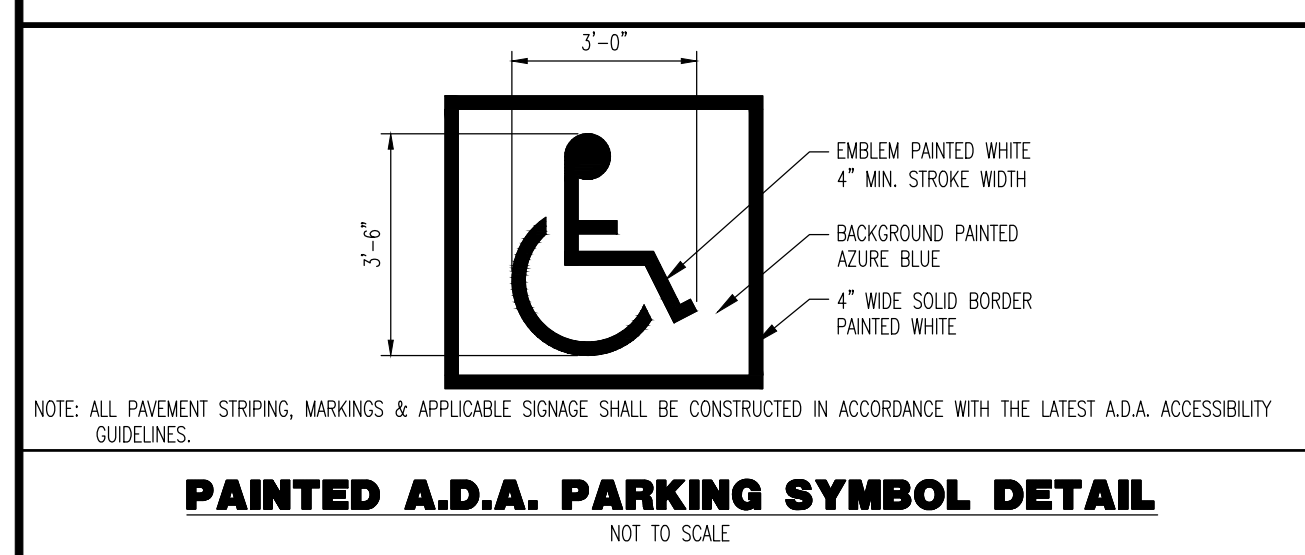

PAINTED A.D.A. PARKING SYMBOL DETAIL

NOT TO SCALE

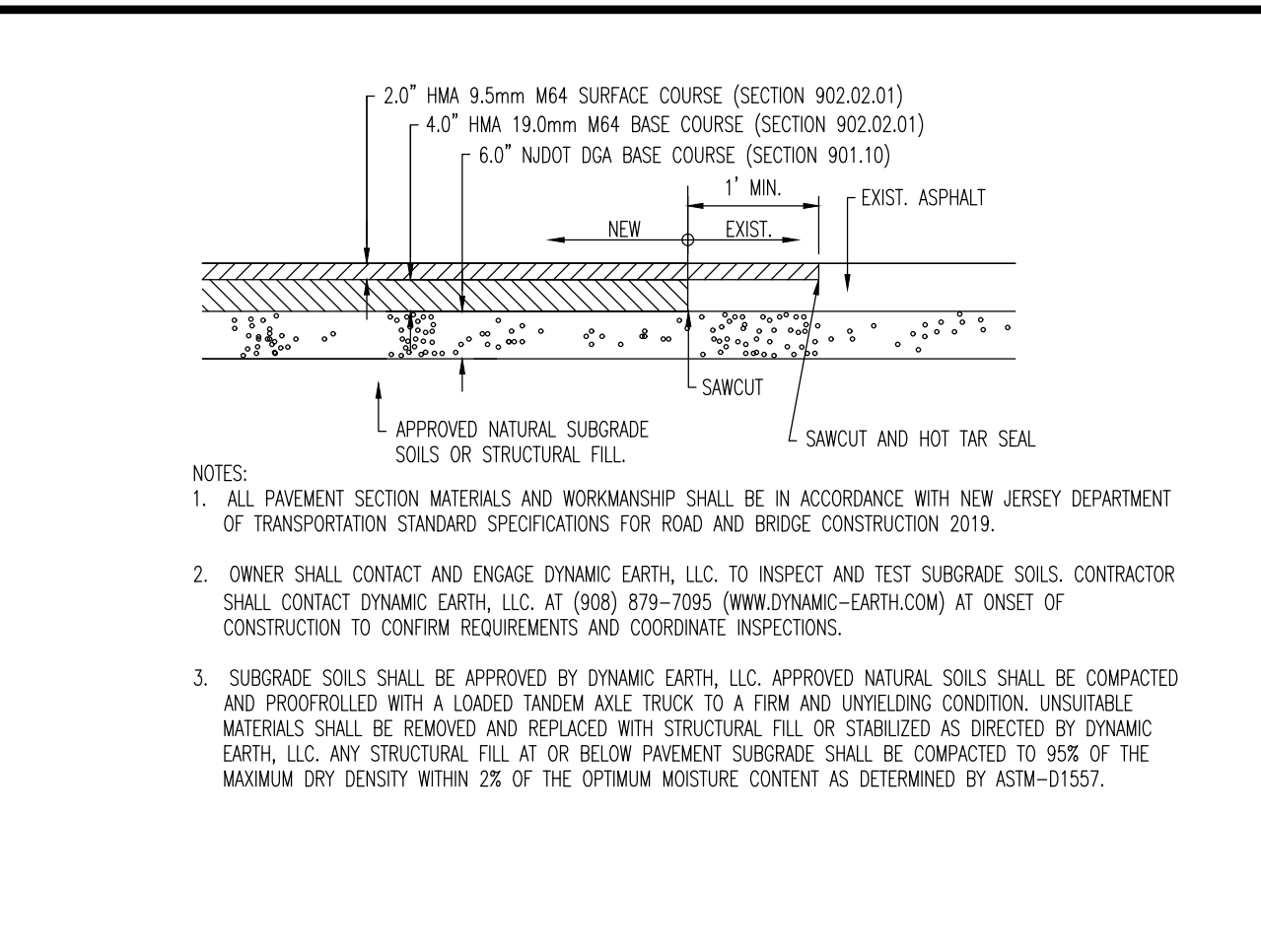

STANDARD DUTY PAVING DETAIL

NOT TO SCALE

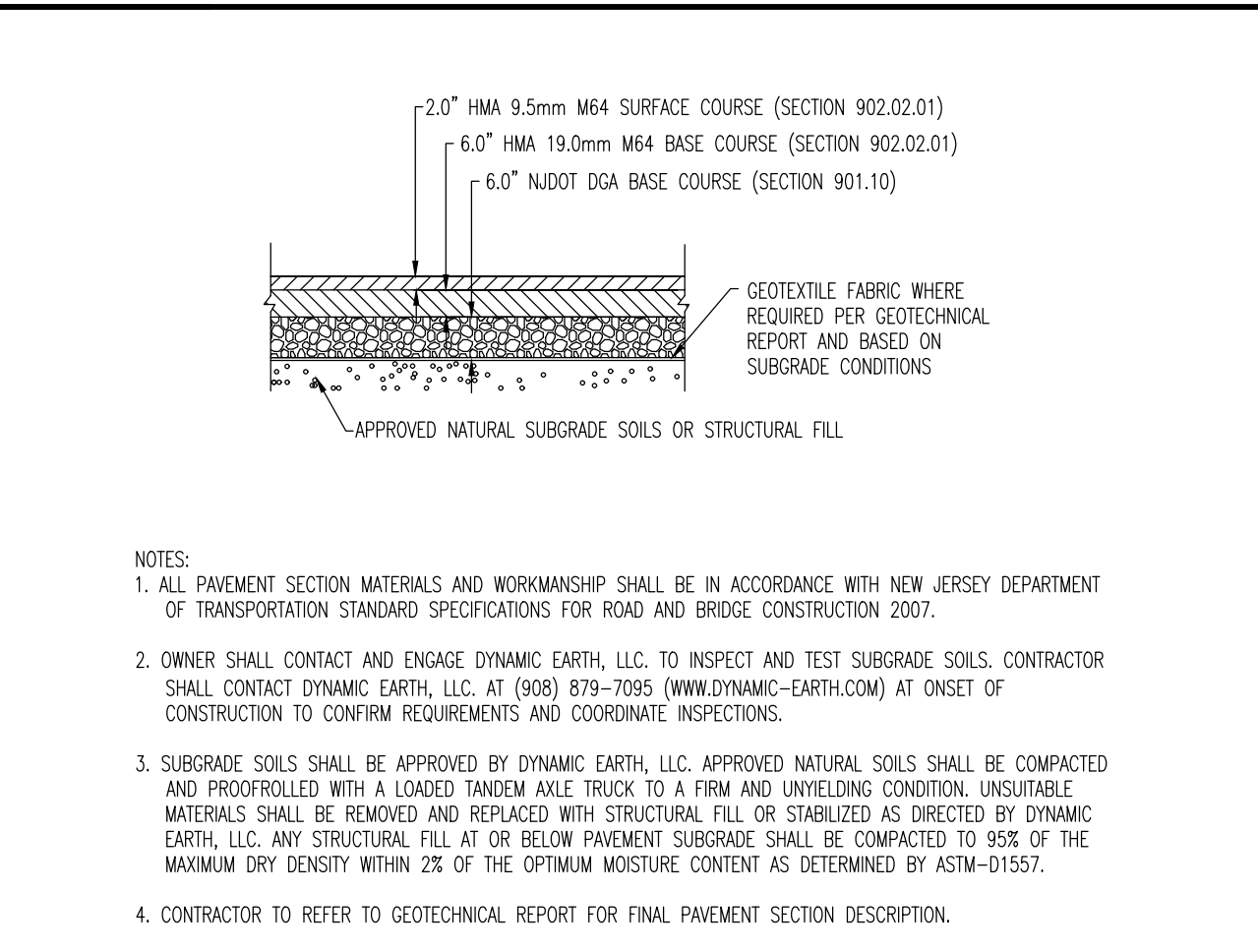

HEAVY DUTY PAVEMENT SECTION

NOT TO SCALE

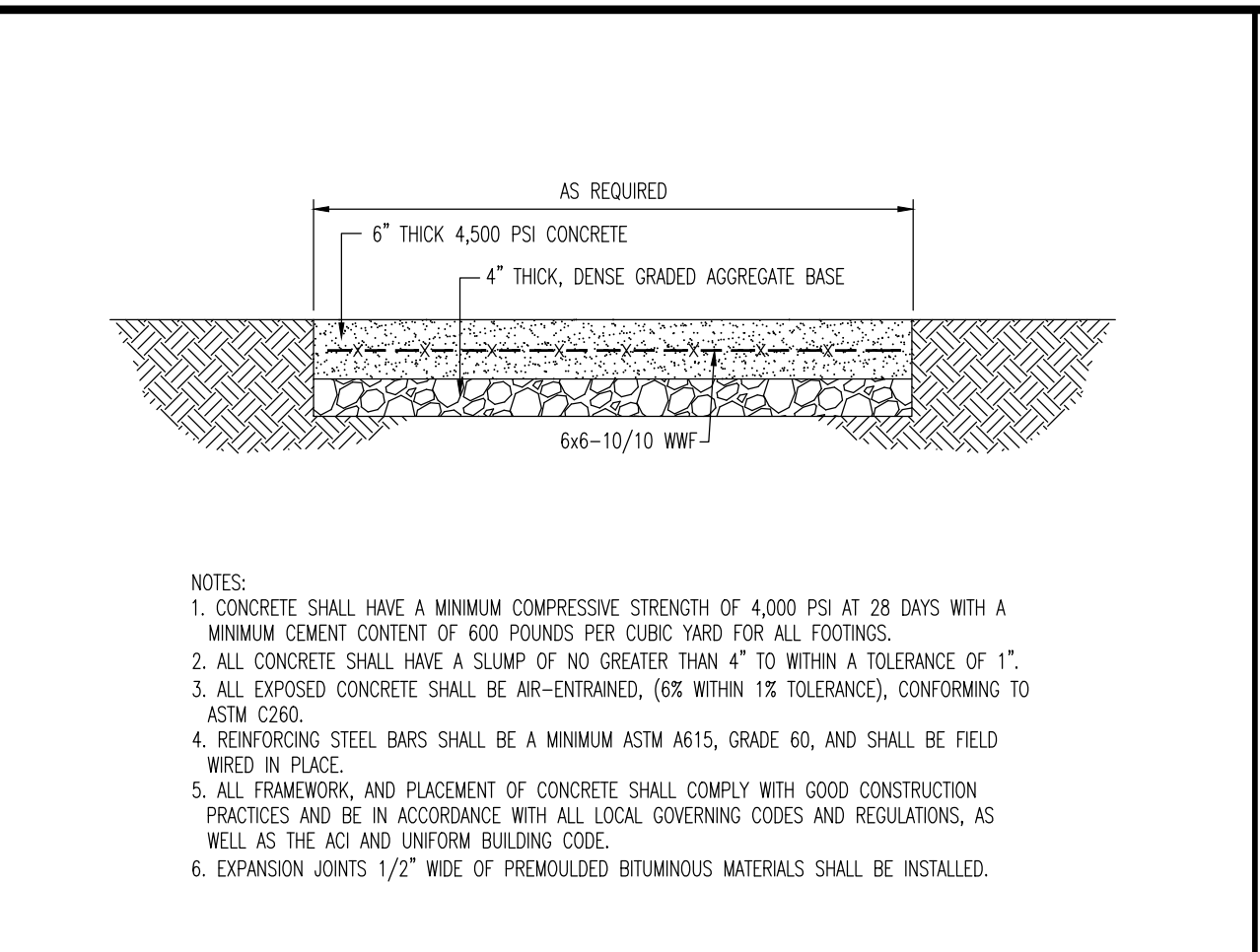

CONCRETE PAD DETAIL

NOT TO SCALE

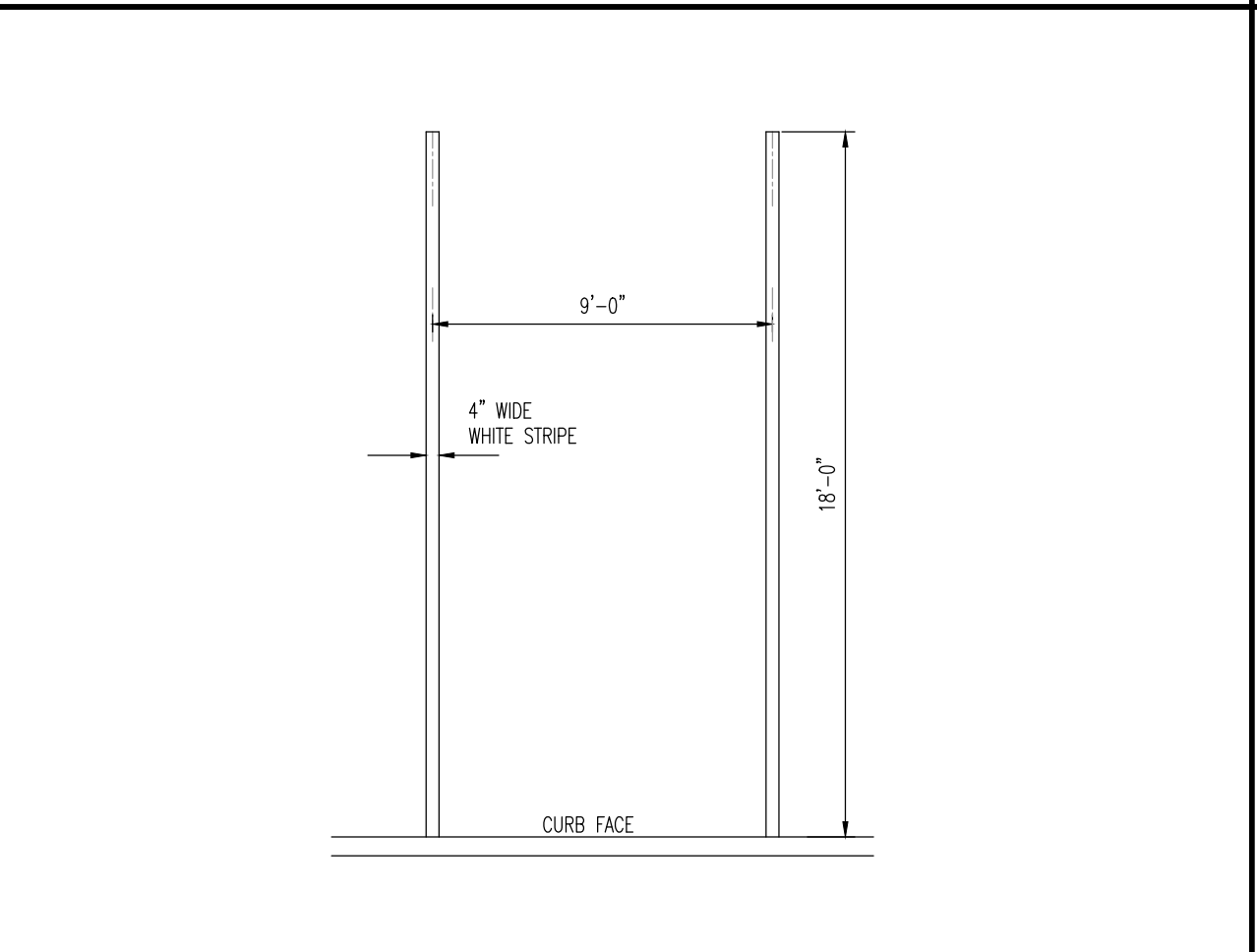

PARKING STALL STRIPING DETAIL

NOT TO SCALE

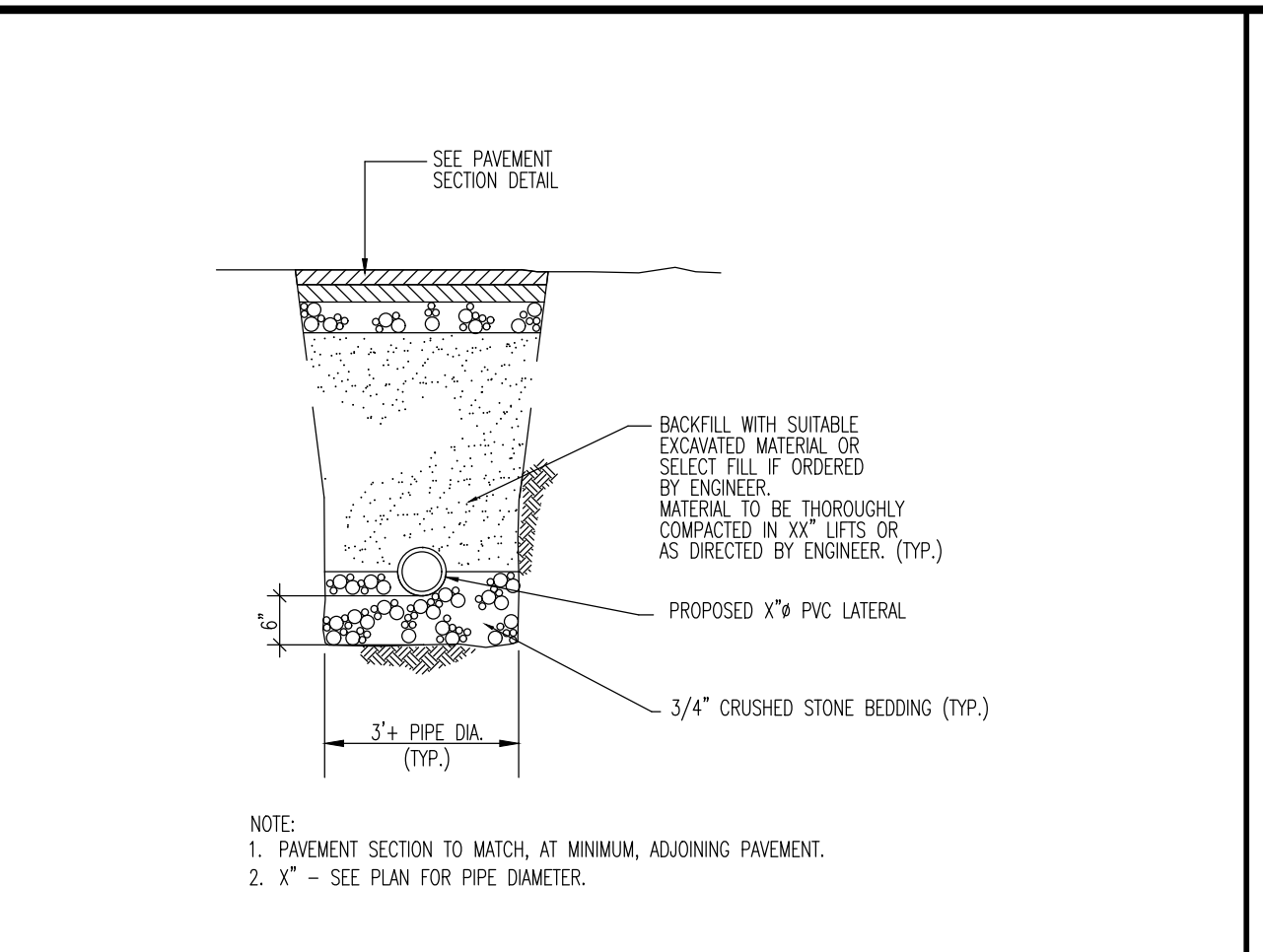

SANITARY SEWER TRENCH DETAIL

NOT TO SCALE

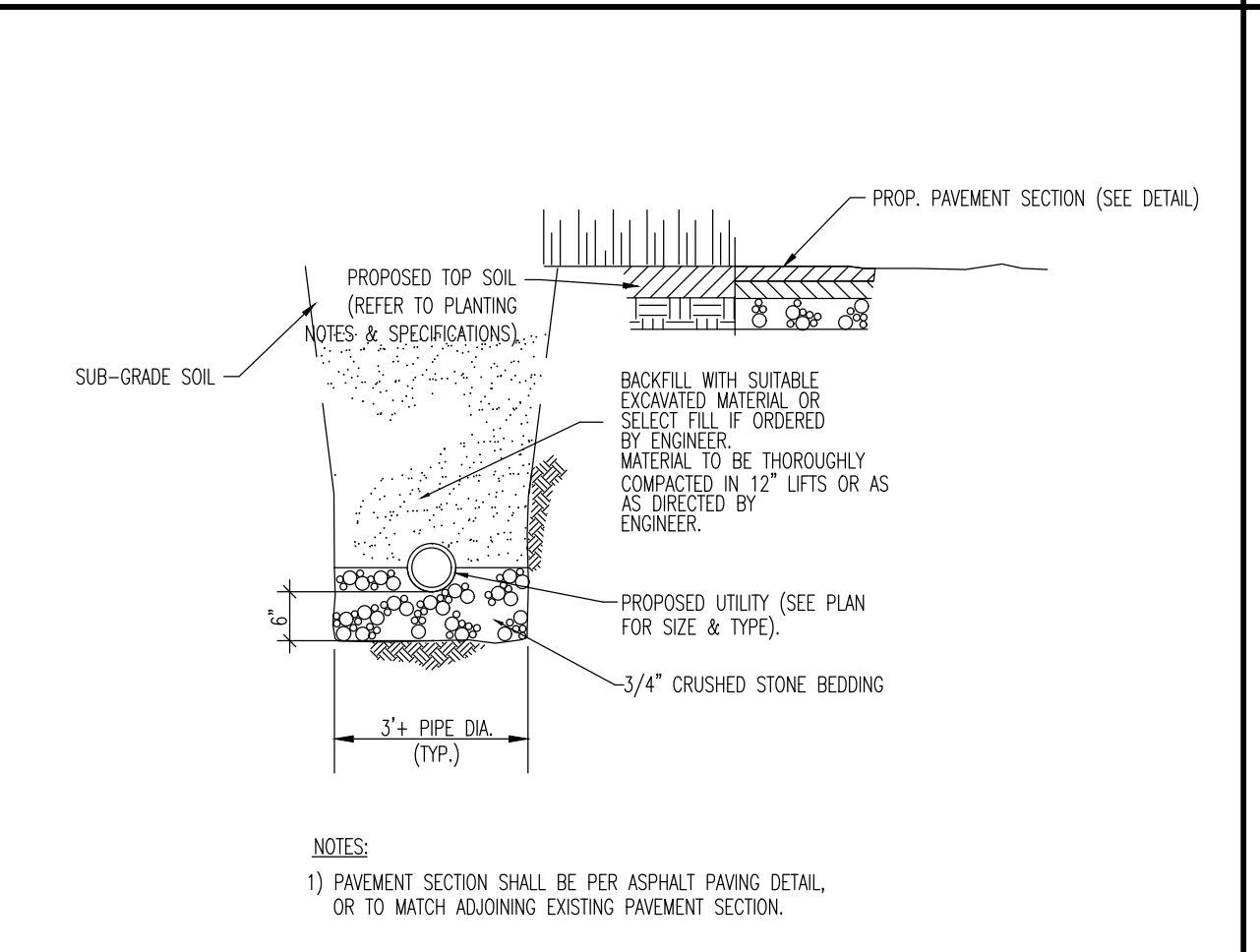

UTILITY SERVICE TRENCH DETAIL

NOT TO SCALE

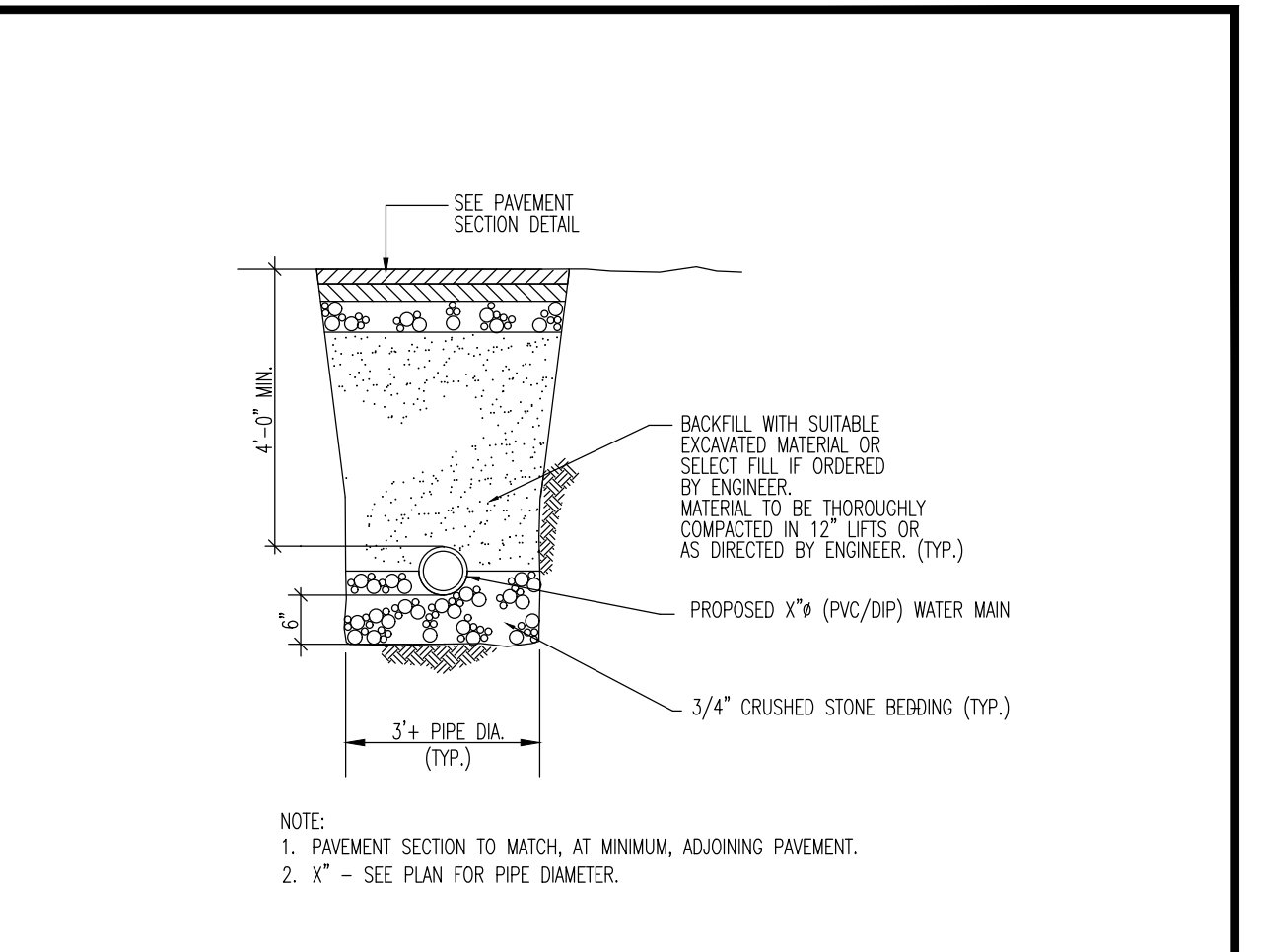

WATER SERVICE TRENCH DETAIL

NOT TO SCALE

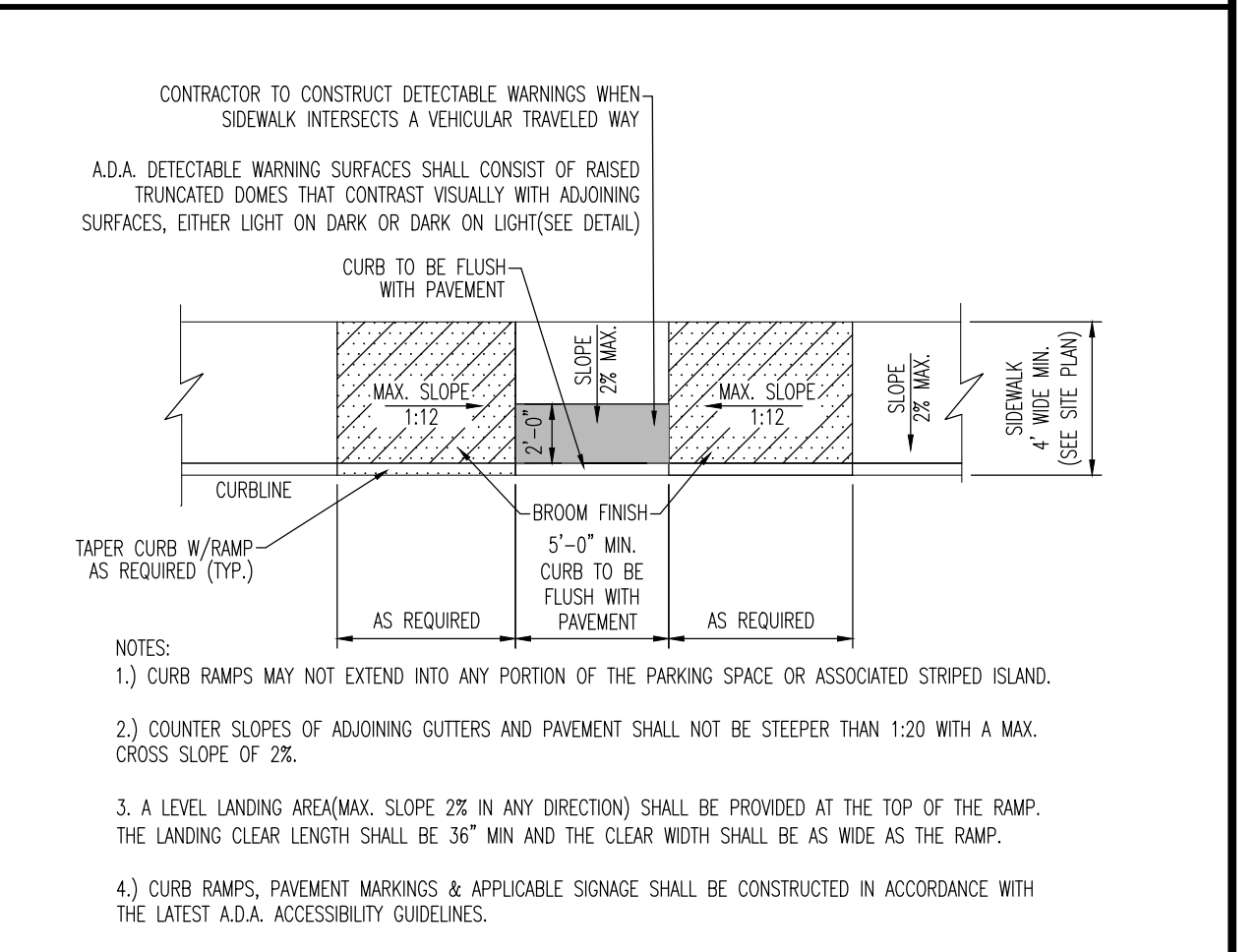

A.D.A. PARALLEL CURB RAMP DETAIL

NOT TO SCALE

ChargePoint CT4000 Family

CT4000 Family Specifications

Electrical Input	Single Port	Dual Port
AC Power Input Rating - Standard	208/240VAC 60Hz single phase @ 30A	208/240VAC 60Hz single phase @ 30 x 2
AC Power Input Rating - Power Sharing	N/A	208/240 VAC 60Hz single phase @ 32A
Input Power Connections - Standard	One 40A branch circuit	Two independent 40A branch circuits
Input Power Connections - Power Sharing	N/A	One 40A branch circuit
Required Service Panel Breaker - Standard	40A dual pole (non-GFCI type)	40A dual pole (non-GFCI type) x 2
Required Service Panel Breaker - Power Sharing	N/A	40A dual pole (non-GFCI type)
Service Panel GFCI	Does not provide external GFCI as it may conflict with internal GFCI (CCO)	5-wire (L1, L2, L3, L4, L5, Earth)
Wiring - Standard	5-wire (L1, L2, L3, L4, L5, Earth)	5-wire (L1, L2, L3, L4, L5, Earth)
Wiring - Power Sharing	N/A	5-wire (L1, L2, L3, L4, L5, Earth)
Station Power	98% typical (standby), 15W maximum (operating)	

Electrical Output

AC - Standard	7.2kW (240VAC @ 30A)	7.2kW (240VAC @ 30A) x 2
AC - Power Sharing	N/A	7.2kW (240VAC @ 30A) x 1 OR 3.8kW (240VAC @ 16A) x 2

Functional Interfaces

Connectivity Type	SAE J1772*	SAE J1772** x 2
Charging Cable Length	18' (5.5 meters)	18' (5.5 meters) x 2
Overhead Cable Management System	Yes	Yes
LED Display	5.7" full color, 640x480, 30fps full motion video, active matrix, UV protected	
Card Reader	ISO 15965, 14443, NFC	
Locking Hardware	Yes	Yes x 2

Safety and Connectivity Features

- Ground Fault Detection: 20mA CCD with auto retry
- Open Safety Ground Detection: Continuously monitors presence of safety (green wire) ground connection
- Plug-Out Detection: Power terminated per SAE J1772** specifications
- Power Measurement Accuracy: +/- 2% from 2% to full scale (32A)
- Power Report/Status Interval: 15 minute, aligned to hour
- Local Area Network: 2.4 GHz Wi-Fi (802.11 b/g/n)
- Wide Area Network: 3G GSM, 3G CDMA

Safety and Operational Ratings

- EMC Rating: Type 30 per UL 508
- Safety Compliance: UL listed for USA and cUL, certified for Canada, complies with UL 2994, UL 2231-UL 2231-2, and NEC Article 625
- Surge Protection: 6kV @ 3000A, 10 geographic areas subject to frequent thunder storms, supplemental surge protection at the service panel is recommended
- EMC Compliance: FCC Part 15 Class A
- Operating Temperature: -20°F to 120°F (-4°C to 49°C)
- Operating Humidity: up to 95% @ +50°C (122°F) non-condensing
- Non-Operating Humidity: up to 95% @ +50°C (122°F) non-condensing
- Terminal Block Temperature Rating: 120°F (50°C)
- Maximum Charging Stations per 802.11 Radio Group: 10. Each station must be located within 150 feet of "line of sight" of a gateway station.

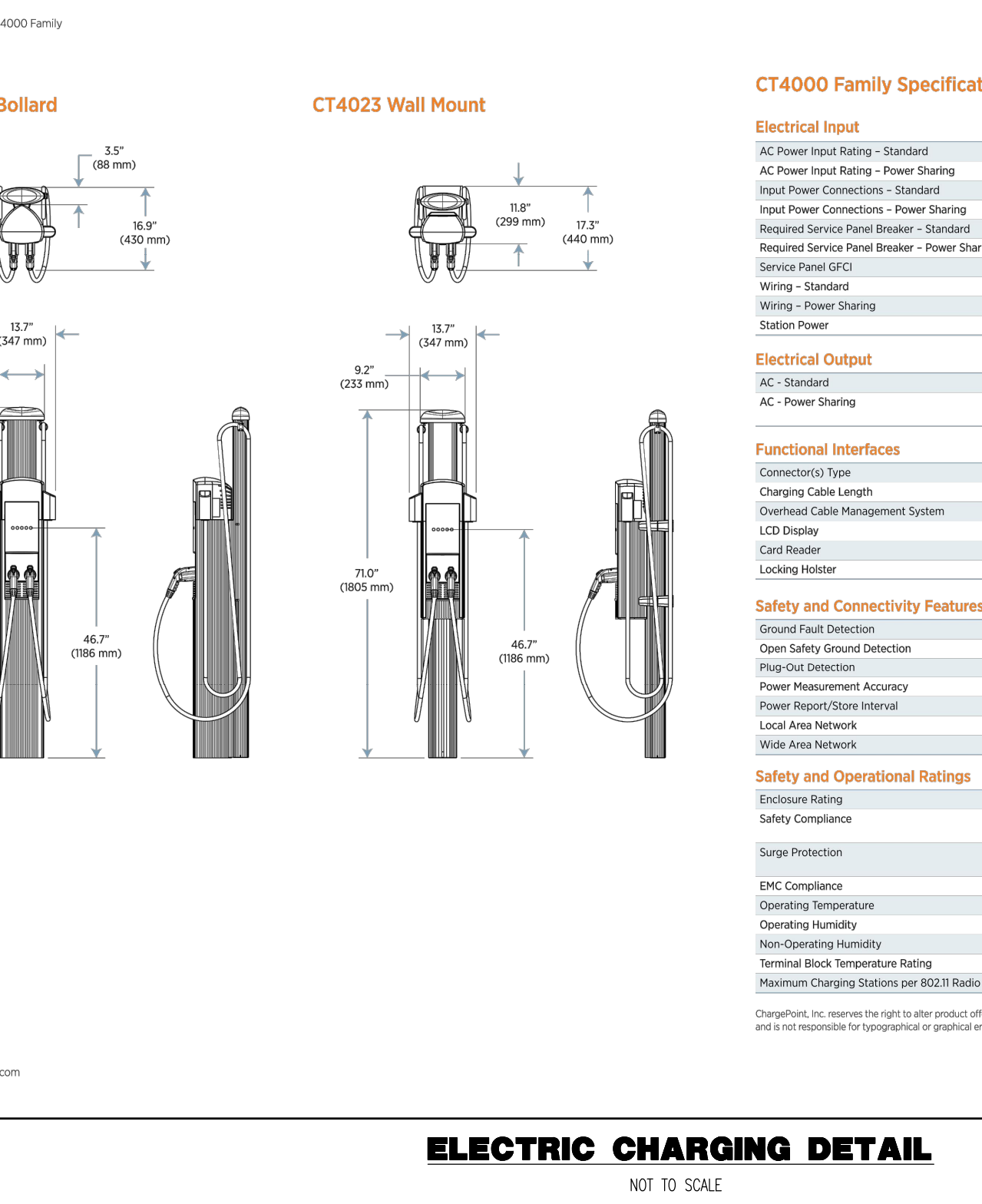

ChargePoint CT4000 Family

Ordering Information

Specify model number followed by the applicable code(s).

Option	Order Code
Model	Single Port Bollard Mount CT4021
	Dual Port Bollard Mount CT4021
	Single Port Wall Mount CT4023
	Dual Port Wall Mount CT4023
Options	Integral Gateway Modern - USA -GWI
	Integral Gateway Modern - Canada -GWC
Warranty	Single Port Extended Hardware-Only CT4000-EKW*
	Dual Port Extended Hardware-Only CT4000-EKW*
	Warranty - 2, 3, 4 or 5 year term
	Warranty - 2, 3, 4 or 5 year term

Order Code Examples

Ordering Info	Order code ex.
Dual Port Bollard Mount USA Gateway Station	CT4023-GWI
Single Port Wall Mount Station with 5 Year Warranty	CT4023-EKW5
Dual Port Wall Mount Canada Gateway Station with 2 Year Warranty	CT4023-GWC
	CT4023-EW2

For More Information

Visit chargepoint.com
Follow us on Twitter @chargepoint
Like us on Facebook @chargepoint

Rev.	Date	Comments	By
1	07/02/22	REV PER TOWNSHIP, DRCC & SCD COMMENTS	KCH

DYNAMIC ENGINEERING

LAND DEVELOPMENT CONSULTING • PERMITTING • GEOTECHNICAL • ENVIRONMENTAL • SURVEY • PLANNING & ZONING

1904 Main Street
Lake Como, NJ 07719
T: 202.974.0198
F: 732.974.3521
www.dynamic.com

CONSTRUCTION DETAILS

PROJECT: **BH 31 SCHOOLHOUSE ROAD LLC**
PROPOSED WAREHOUSE
BLOCK 517.04 LOT 21.03
31 SCHOOLHOUSE ROAD
TOWNSHIP OF FRANKLIN, SOMERSET COUNTY, NEW JERSEY

JOB No: 2906-99-003
DATE: 03/03/2022
DRAWN BY: NSR
SCALE: (H) NOT TO (V) SCALE
DESIGNED BY: AG
SHEET No: 17
CHECKED BY: KCK
Rev. # 24

KYLE C. KAVINSKI
PROFESSIONAL ENGINEER
NEW JERSEY LICENSE No. 52985

JOSHUA M. SEWALD
PROFESSIONAL ENGINEER
NEW JERSEY LICENSE No. 52908

ALL USERS REQUIRE REGISTRATION OF SOFTWARE. REGISTRATION OF ANY USER PREVIOUS TO ACCESS THE SERVICE. SERVICE AGREEMENT IS AT THE END OF THE CALL.

FOR STATE SPECIFICATIONS VISIT: WWW.CALL811.COM