

GENERAL NOTES — PLANTING

1. VERIFY LOCATIONS OF ALL UTILITIES PRIOR TO EXCAVATION OF PLANT PITS.
2. VERIFY LAYOUT OF ALL WORK WITH EXISTING CONDITIONS. IMMEDIATELY REPORT ALL DISCREPANCIES TO LANDSCAPE ARCHITECT.
3. PROVIDE STAKED LAYOUT OF ALL WORK FOR APPROVAL BY LANDSCAPE ARCHITECT.
4. MULCH ALL PLANT BEDS TO A DEPTH OF 2". SHALL BE KEPT 1" MIN. AWAY FROM TRUNK OF ALL TREES, SHRUBS, AND FOLIAGE OF ALL PERENNIALS.

PLANT SCHEDULE

| KEY | QTY | BOTANICAL NAME | COMMON NAME | SIZE | SPACING | COMMENT |
|---------------|-----|--------------------------------|----------------------------|----------------|----------|-----------------------|
| TREES | | | | | | |
| AP | 56 | AESCULUS PAVIA | RED BUCKEYE | 6'-8" HT | AS SHOWN | |
| CS | 18 | CATALPA SPECIOSA | NORTHERN CATALPA | 2 1/2"-3" CAL. | AS SHOWN | |
| CC | 70 | CERCIS CANADENSIS | REDBUD | 6'-8" HT | AS SHOWN | MULTI-STEM, 3-5 CANES |
| CA | 51 | CORNUS ALTERNIFOLIA | PAGODA DOGWOOD | 6'-8" HT | AS SHOWN | |
| HC | 44 | HALESIA CAROLINA | SILVERBELL | 6'-8" HT. | AS SHOWN | |
| IO | 53 | ILEX OPACA | AMERICAN HOLLY | 6'-8" HT. | AS SHOWN | |
| JV | 19 | JUNIPERUS VIRGINIANA | EASTERN REDCEDAR | 6'-8" HT. | AS SHOWN | |
| MV | 28 | MAGNOLIA VIRGINIANA 'MOONGLOW' | MOONGLOW SWEETBAY MAGNOLIA | 6'-8" HT. | AS SHOWN | MULTI-STEM, 3-5 CANES |
| NS | 13 | NYSSA SYLVATICA | BLACK GUM | 2 1/2"-3" CAL. | AS SHOWN | |
| PS | 35 | PINUS STROBUS | WHITE PINE | 6'-8" HT. | AS SHOWN | |
| PV | 27 | PINUS VIRGINIANA | VIRGINIA PINE | 6'-8" HT. | AS SHOWN | |
| PO | 11 | PLATANUS OCCIDENTALIS | AMERICAN SYCAMORE | 2 1/2"-3" CAL. | AS SHOWN | |
| QA | 9 | QUERCUS ALBA | WHITE OAK | 2 1/2"-3" CAL. | AS SHOWN | |
| QB | 12 | QUERCUS BICOLOR | SWAMP WHITE OAK | 2 1/2"-3" CAL. | AS SHOWN | |
| QI | 13 | QUERCUS IMBRICARIA | SHINGLE OAK | 2 1/2"-3" CAL. | AS SHOWN | |
| QM | 18 | QUERCUS MONTANA | CHESTNUT OAK | 2 1/2"-3" CAL. | AS SHOWN | |
| QP | 22 | QUERCUS PALUSTRIS | PIN OAK | 2 1/2"-3" CAL. | AS SHOWN | |
| SA | 13 | SALIX AMYGDALOIDES | PEACHLEAF WILLOW | 6'-8" HT. | AS SHOWN | |
| TD | 4 | TAXODIUM DISTICHUM | BALD CYPRESS | 6'-8" HT. | AS SHOWN | |
| TO | 16 | THUJA OCCIDENTALIS | AMERICAN ARBORVITAE | 2 1/2"-3" CAL. | AS SHOWN | |
| SHRUBS | | | | | | |
| CO | 19 | CEPHALANTHUS OCCIDENTALIS | BUTTONWOOD | 36" HT. | CONT. | AS SHOWN |
| IC | 40 | ILEX GLABRA | INKBERRY HOLLY | 36" HT. | CONT. | AS SHOWN |
| MC | 10 | MORELLA (MYRICA) CERIFERA | SOUTHERN WAX MYRTLE | 36" HT. | CONT. | AS SHOWN |
| MP | 30 | MORELLA (MYRICA) PENNSYLVANICA | NORTHERN BAYBERRY | 36" HT. | CONT. | AS SHOWN |
| RC | 16 | ROSA CAROLINA | CAROLINA ROSE | 36" HT. | CONT. | AS SHOWN |
| RP | 24 | ROSA PALUSTRIS | SWAMP ROSE | 36" HT. | CONT. | AS SHOWN |

BUFFER AND LANDSCAPE REQUIREMENTS
 A. BUFFER ZONE AREA NOT LESS THAN 50 FEET IN WIDTH AND CONSISTING OF MASS EVERGREEN PLANTINGS AND A SOLID 6-FOOT HIGH FENCE SHALL BE REQUIRED ALONG AND ABUTTING ALL RESIDENTIAL ZONE BOUNDARIES, INCLUDING THE PAC, SCV, CMMR AND C-R ZONES, EXCEPT THAT NO BUFFER SHALL BE REQUIRED WITHIN AN ARTERIAL STREET OR HIGHWAY AS SHOWN ON THE ADOPTED MASTER PLAN OF THE TOWNSHIP OF FRANKLIN LOCATED BETWEEN THE B-1 ZONE AND SUCH RESIDENTIAL ZONE. SUCH BUFFER AREA SHALL INCREASE TO 75 FEET FOR SITES CONTAINING A BUILDING TALLER THAN 50 FEET IN BUILDING HEIGHT. REFER TO SCHEDULE 2, LOT AND YARD REQUIREMENTS, FOR APPLICABLE BUILDING SETBACKS, WITH THE EXCEPTION OF NECESSARY ACCESS DRIVE(S) AND FENCING OR OTHER SCREENING APPROVED AS PART OF DEVELOPMENT APPLICATION. NO IMPROVEMENTS (E.G., STORMWATER BASIN, PARKING LOTS, ETC.) MAY BE PERMITTED WITHIN SUCH BUFFER AREAS. (§112 ATTACHMENT 6)

B. EVERGREEN AND DECIDUOUS TREES SHALL BE REQUIRED IN ALL SIDE AND/OR REAR YARD AREAS WHICH ABUT RESIDENTIAL ZONE BOUNDARY LINES. ONE TREE SHALL BE REQUIRED FOR EACH FIVE-FOOT LENGTH OF SIDE AND/OR REAR YARD AREA. EVERGREEN TREES SHALL BE AT LEAST SIX FEET IN HEIGHT AT THE TIME OF PLANTING, AND DECIDUOUS TREES SHALL BE AT LEAST 2 1/2" INCHES CALIPER. (§112 ATTACHMENT 6)
 C. THE APPROVING AUTHORITY MAY WAIVE ALL OR A PORTION OF THE REQUIRED LANDSCAPING IF ADEQUATE NUMBERS OF TREES EXIST OR FOR REASON OF TOPOGRAPHICAL CHANGE. (§112 ATTACHMENT 6)
 D. LANDSCAPING ON SITE SHALL INCLUDE ONE TREE (DECIDUOUS TREES AT LEAST 2 1/2" CALIPER AND EVERGREENS AT LEAST 6 FEET IN HEIGHT FOR EACH 2000 SQUARE FEET OF PAVED AREA. (§112 ATTACHMENT 6)

CLIENT:
LINK
 LINK LOGISTICS
 1 FAYETTE STREET, SUITE 200
 COOKSBOURNE, PA 19426
 PHONE: (247) 705-6222

LANDSCAPE ARCHITECT:
STUDIO|BRYAN HANES
 340 N. 12TH STREET, SUITE 415
 PHILADELPHIA, PA 19107
 PHONE: 215-923-2858

104 SCHOOLHOUSE
 SOMERSET, NJ

PLANTING PLAN

SCALE: 1" = 50'-0"
 DRAWN BY: BH
 CHECKED BY: BH
 CAD FILE:
 DATE: 11/22/2022
 PROJECT NO.: 2209 (SBH)

| REVISIONS | DATE | DESCRIPTION |
|-----------|------------|-----------------|
| 1 | 11/22/2022 | TOWNSHIP REVIEW |

L1.00

NOT FOR CONSTRUCTION

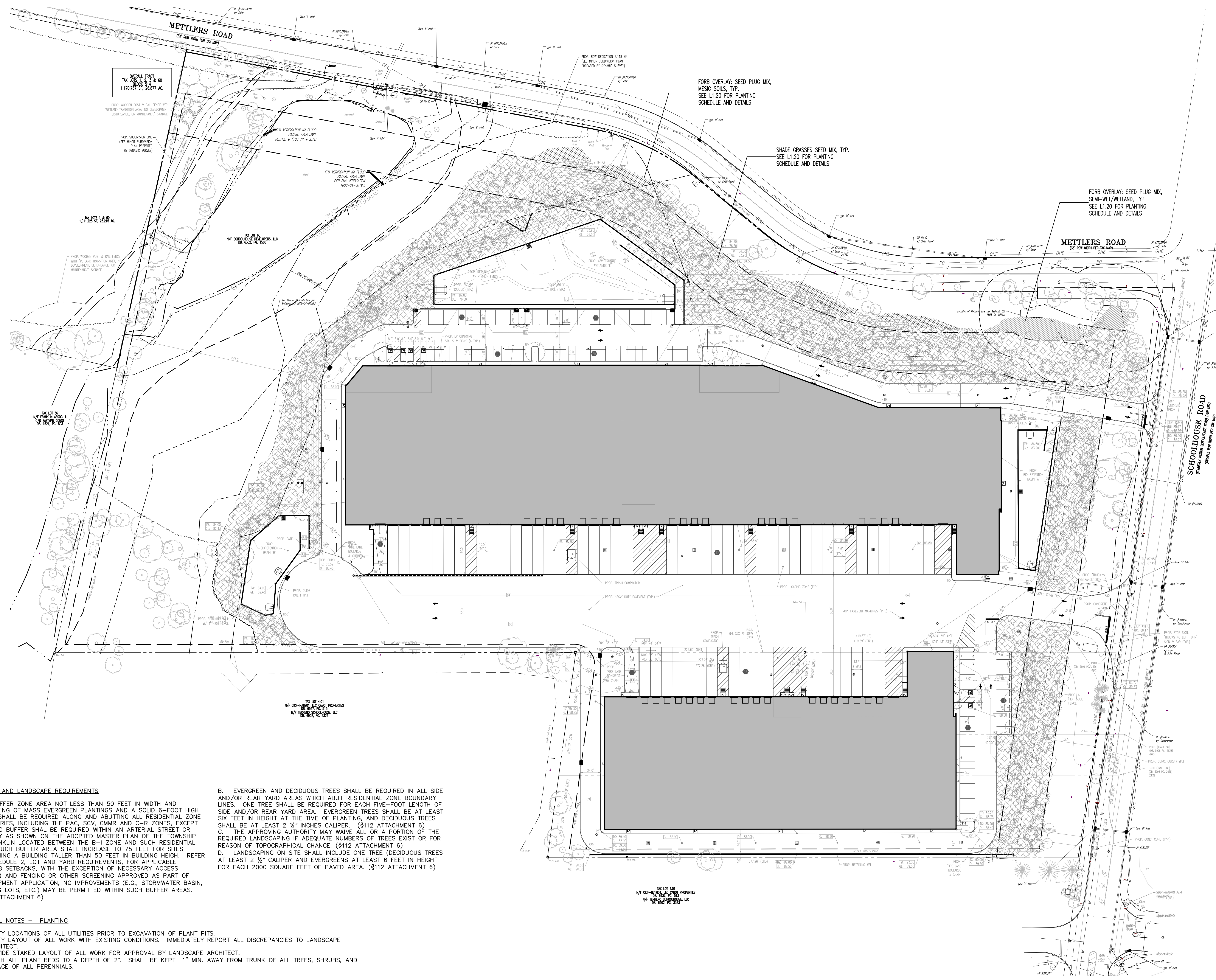

BUFFER AND LANDSCAPE REQUIREMENTS

A. BUFFER ZONE AREA NOT LESS THAN 50 FEET IN WIDTH AND CONSISTING OF MASS EVERGREEN PLANTINGS AND A SOLID 6-FOOT HIGH FENCE SHALL BE REQUIRED ALONG AND ADJUTING ALL RESIDENTIAL ZONE BOUNDARIES, INCLUDING THE PAC, SCV, CMMR AND C-R ZONES, EXCEPT THAT NO BUFFER SHALL BE REQUIRED WITHIN AN ARTERIAL STREET OR HIGHWAY AS SHOWN ON THE ADOPTED MASTER PLAN OF THE TOWNSHIP OF FRANKLIN LOCATED BETWEEN THE B-1 ZONE AND SUCH RESIDENTIAL ZONE. SUCH BUFFER AREA SHALL INCREASE TO 75 FEET FOR SITES CONTAINING A BUILDING TALLER THAN 50 FEET IN BUILDING HEIGHT. REFER TO SCHEDULE 2, LOT AND YARD REQUIREMENTS, FOR APPLICABLE BUILDING SETBACKS, WITH THE EXCEPTION OF NECESSARY ACCESS DRIVE(S) AND FENCING OR OTHER SCREENING APPROVED AS PART OF DEVELOPMENT APPLICATION. NO IMPROVEMENTS (E.G., STORMWATER BASIN, PARKING LOTS, ETC.) MAY BE PERMITTED WITHIN SUCH BUFFER AREAS. (§112 ATTACHMENT 6)

B. EVERGREEN AND DECIDUOUS TREES SHALL BE REQUIRED IN ALL SIDE AND/OR REAR YARD AREAS WHICH ABUT RESIDENTIAL ZONE BOUNDARY LINES. ONE TREE SHALL BE REQUIRED FOR EACH FIVE-FOOT LENGTH OF SIDE AND/OR REAR YARD AREA. EVERGREEN TREES SHALL BE AT LEAST SIX FEET IN HEIGHT AT THE TIME OF PLANTING, AND DECIDUOUS TREES SHALL BE AT LEAST 2 1/2" INCHES CALIPER. (§112 ATTACHMENT 6)

C. THE APPROVING AUTHORITY MAY WAIVE ALL OR A PORTION OF THE REQUIRED LANDSCAPING IF ADEQUATE NUMBERS OF TREES EXIST OR FOR REASON OF TOPOGRAPHICAL CHANGE. (§112 ATTACHMENT 6)

D. LANDSCAPING ON SITE SHALL INCLUDE ONE TREE (DECIDUOUS TREES AT LEAST 2 1/2" CALIPER AND EVERGREENS AT LEAST 6 FEET IN HEIGHT FOR EACH 2000 SQUARE FEET OF PAVED AREA. (§112 ATTACHMENT 6)

GENERAL NOTES - PLANTING

1. VERIFY LOCATIONS OF ALL UTILITIES PRIOR TO EXCAVATION OF PLANT PITS.
2. VERIFY LAYOUT OF ALL WORK WITH EXISTING CONDITIONS. IMMEDIATELY REPORT ALL DISCREPANCIES TO LANDSCAPE ARCHITECT.
3. PROVIDE STAKED LAYOUT OF ALL WORK FOR APPROVAL BY LANDSCAPE ARCHITECT.
4. MULCH ALL PLANT BEDS TO A DEPTH OF 2". SHALL BE KEPT 1" MIN. AWAY FROM TRUNK OF ALL TREES, SHRUBS, AND FOLIAGE OF ALL PERENNIALS.



LINK LOGISTICS
1 FAYETTE STREET, SUITE 280
CONSHOHOCKEN, PA 19028
PHONE: (215) 708-6222



340 N. 12TH STREET, SUITE 415
PHILADELPHIA, PA 19107
PHONE: 215-923-2888

**104
SCHOOLHOUSE**
SOMERSET, NJ

**PLANTING PLAN
GROUND LAYER**

SCALE: 1" = 50'
DRAWN BY: BH
CHECKED BY: BH
DATE: 11/22/2022
PROJECT NO.: 2209 (SBH)

| REVISIONS | DATE | DESCRIPTION |
|-----------|------------|-----------------|
| 1 | 11/22/2022 | TOWNSHIP REVIEW |

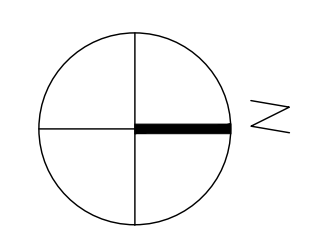

L1.10

NOT FOR CONSTRUCTION

PLANT SCHEDULE

| KEY | QTY | BOTANICAL NAME | COMMON NAME | | % OF MIX |
|--|-----|--------------------------------------|---------------------------|-------|--------------------|
| FORB PLUG OVERLAY: MESIC SOILS - LANDSCAPE PLUGS 15" O.C., TRIANGLE SPACING | | | | | 7 TOTAL SPECIES |
| AREA (ACRES) = ±0.1 | | | | | 2,620 PLUGS TOTAL |
| AREA (SF) = 3,550 | | | | | |
| AT | XX | ASCLEPIAS TUBEROSA | BUTTERFLYWEED | UPL | LANDSCAPE PLUG 5% |
| AV | XX | ASCLEPIAS VERTICILLATA | WHORLED MILKWEED | UPL | LANDSCAPE PLUG 15% |
| CF | XX | CHAMAECRISTA FASCICULATA | PARTRIDGE PEA | FACU | LANDSCAPE PLUG 15% |
| EG | XX | EUTHAMIA GRAMINIFOLIA | THIN-LEAF GOLDENROD | FAC | LANDSCAPE PLUG 20% |
| MF | XX | MONARDA FISTULOSA | WILD BERGAMOT | UPL | LANDSCAPE PLUG 20% |
| SF | XX | SOLIDAGO FLEXICAULIS | ZIG-ZAG GOLDENROD | FACU | LANDSCAPE PLUG 10% |
| ZA | XX | ZIZIA AUREA | GOLDEN ALEXANDER | FAC | LANDSCAPE PLUG 15% |
| FORB SEED OVERLAY: MESIC SOILS | | | | | 6 TOTAL SPECIES |
| CL | XX | COREOPSIS LANCEOLATA | TICKSEED | FACU | SEED 20% |
| CF | XX | CHAMAECRISTA FASCICULATA | PARTRIDGE PEA | FACU | SEED 15% |
| MF | XX | MONARDA FISTULOSA | WILD BERGAMOT | UPL | SEED 15% |
| RH | XX | RUDBECKIA HIRTA | BLACK-EYED SUSAN | FACU- | SEED 20% |
| VV | XX | VERONICASTRUM VIRGINICUM | CULVER'S ROOT | FACU | SEED 10% |
| ZA | XX | ZIZIA AUREA | GOLDEN ALEXANDER | FAC | SEED 20% |
| FORB PLUG OVERLAY: SEMI-WET/WETLAND - LANDSCAPE PLUGS 15" O.C., TRIANGLE SPACING | | | | | 10 TOTAL SPECIES |
| AREA (ACRES) = ±0.07 | | | | | 2,362 PLUGS TOTAL |
| AREA (SF) = 3,200 | | | | | |
| AC | XX | APOCYNUM CANNIBINUM | DOGBANE | FAC | LANDSCAPE PLUG 5% |
| AI | XX | ASCLEPIAS INCARNATA | SWAMP MILKWEED | OBL | LANDSCAPE PLUG 5% |
| ED | XX | EUPATORIUM DUBIUM 'BABY JOE' | THREE-NERVED JOE PYE WEED | FACW | LANDSCAPE PLUG 15% |
| IV | XX | IRIS VERSICOLOR | BLUE FLAG IRIS | FACW+ | LANDSCAPE PLUG 10% |
| LC | XX | LOBELIA CARDINALIS | CARDINAL FLOWER | OBL | LANDSCAPE PLUG 10% |
| PM | XX | PYCNANTHEMUM MUTICUM | BIG-LEAF MOUNTAIN MINT | FACW | LANDSCAPE PLUG 15% |
| SA | XX | SENECIO AUREUS | GOLDEN GROUNDSEL | FACW | LANDSCAPE PLUG 10% |
| VH | XX | VERBENA HASTATA | BLUE VERVAIN | FACW+ | LANDSCAPE PLUG 10% |
| VL | XX | VERNONIA LETTERMANII 'IRON BUTTERLY' | NARROW-LEAF IRONWEED | FACW | LANDSCAPE PLUG 10% |
| VN | XX | VERNONIA NOVEBORACENSIS | NEW YORK IRONWEED | FACW+ | LANDSCAPE PLUG 10% |
| FORB SEED OVERLAY: SEMI-WET/WETLAND | | | | | 3 TOTAL SPECIES |
| LC | XX | LOBELIA CARDINALIS | CARDINAL FLOWER | OBL | SEED 50% |
| PM | XX | PYCNANTHEMUM MUTICUM | BIG-LEAF MOUNTAIN MINT | FACW | SEED 25% |
| SA | XX | SENECIO AUREUS | GOLDEN GROUNDSEL | FACW | SEED 25% |

PRIMARY: SHADE GRASS MIX

AREA (ACRES) = ±2.9 24 LBS OF SEED / ACRE
 AREA (SF) = 125,400 SEEDS PER SF = 100 7 TOTAL SPECIES

| BOTANICAL NAME | COMMON NAME | % OF MIX (BY INDIVIDUAL) | |
|-------------------------|-------------------|--------------------------|-----------------|
| AVENA SATIVA* | OATS | 5% | 189.5 OZ ANNUAL |
| SCHIZACHYRIUM SCOPARIUM | LITTLE BLUESTEM | 25% | 74.7 OZ WARM |
| ELYMUS HYSTRIX | BOTTLEBRUSH GRASS | 6% | 57.6 OZ COOL |
| DANTHONIA SPICATA | POVERTY OATGRASS | 3% | 5.4 OZ COOL |
| DESCHAMPSIA CESPITOSA | TUFTED HAIRGRASS | 10% | 6.5 OZ COOL |
| ELYMUS VIRGINICUS | VIRGINIA WILD RYE | 6% | 57.6 OZ COOL |
| JUNCUS TENUIS | PATH RUSH | 45% | 1.1 OZ COOL |

*USE WITH SPRING/SUMMER SEEDINGS ONLY. IF SEEDING IN FALL/DORMANCY, CONSULT LANDSCAPE ARCH. FOR ALTERNATE COVER CROP

HARDINESS ZONE: 6B
 ECOREGION: TRIASSIC LOWLANDS/NO. PIEDMONT
 SOIL FERTILITY: MODERATE (ASSUMED)

USE THE FOLLOWING ECOTYPES IF AVAILABLE: NJ

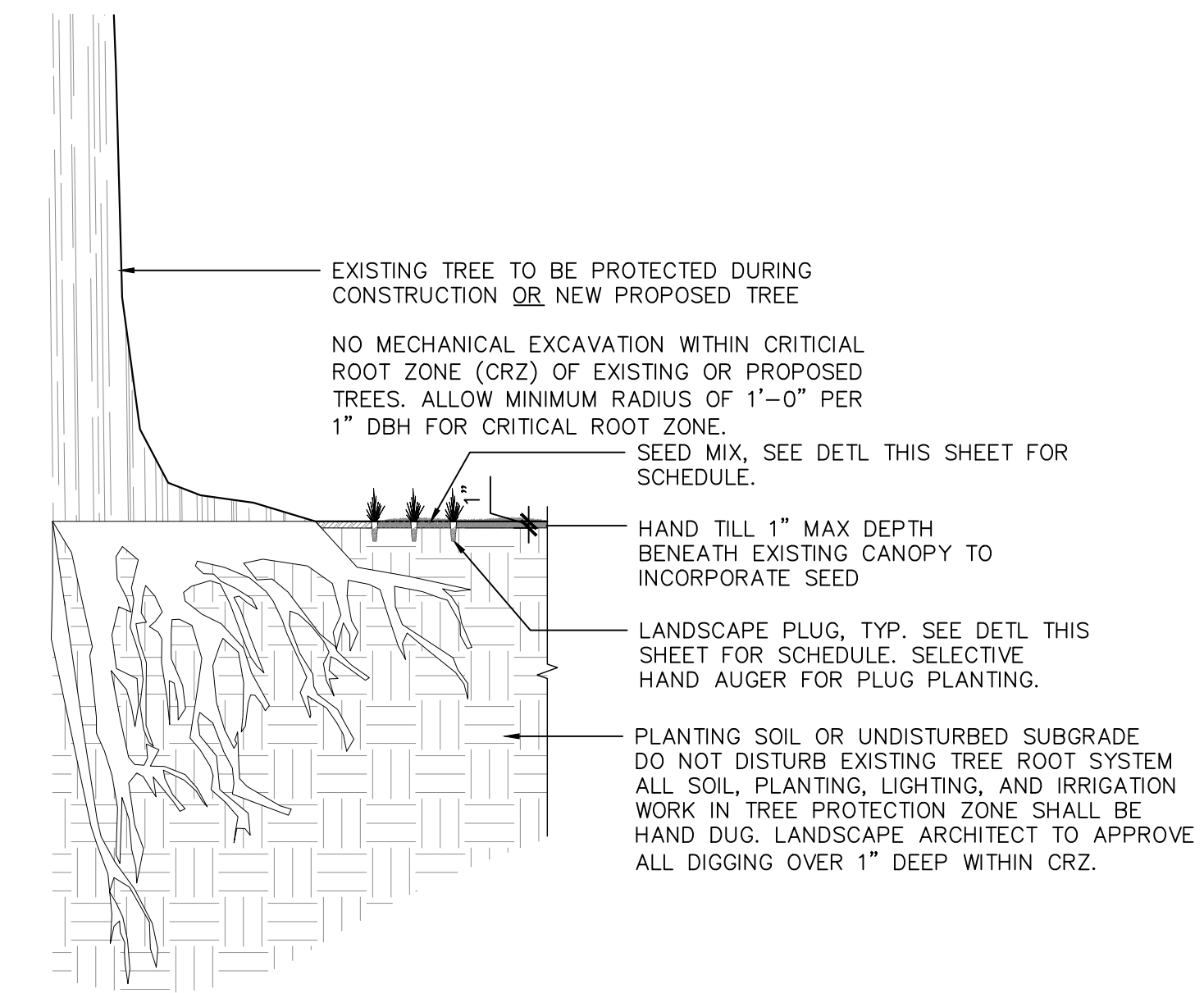

4 SEED/PLUG PLANTING @ TREE, TYP.
 1/8" = 1'-0"

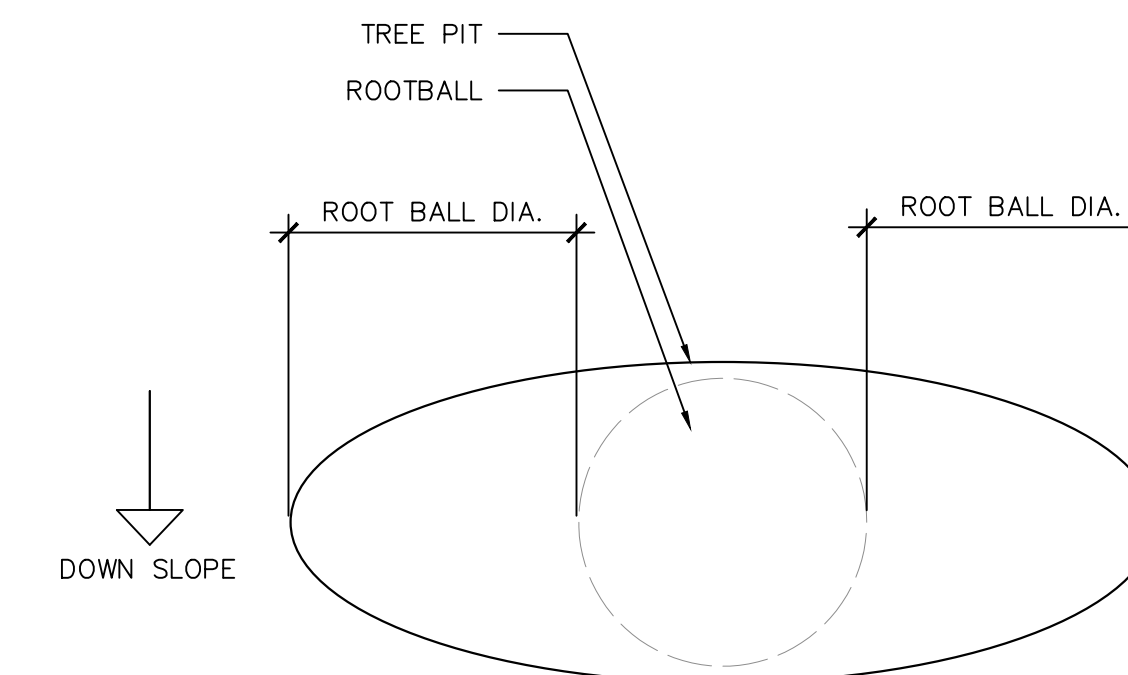

3 TREE PLANTING ON SLOPE, TYP. - PLAN
 N.T.S.

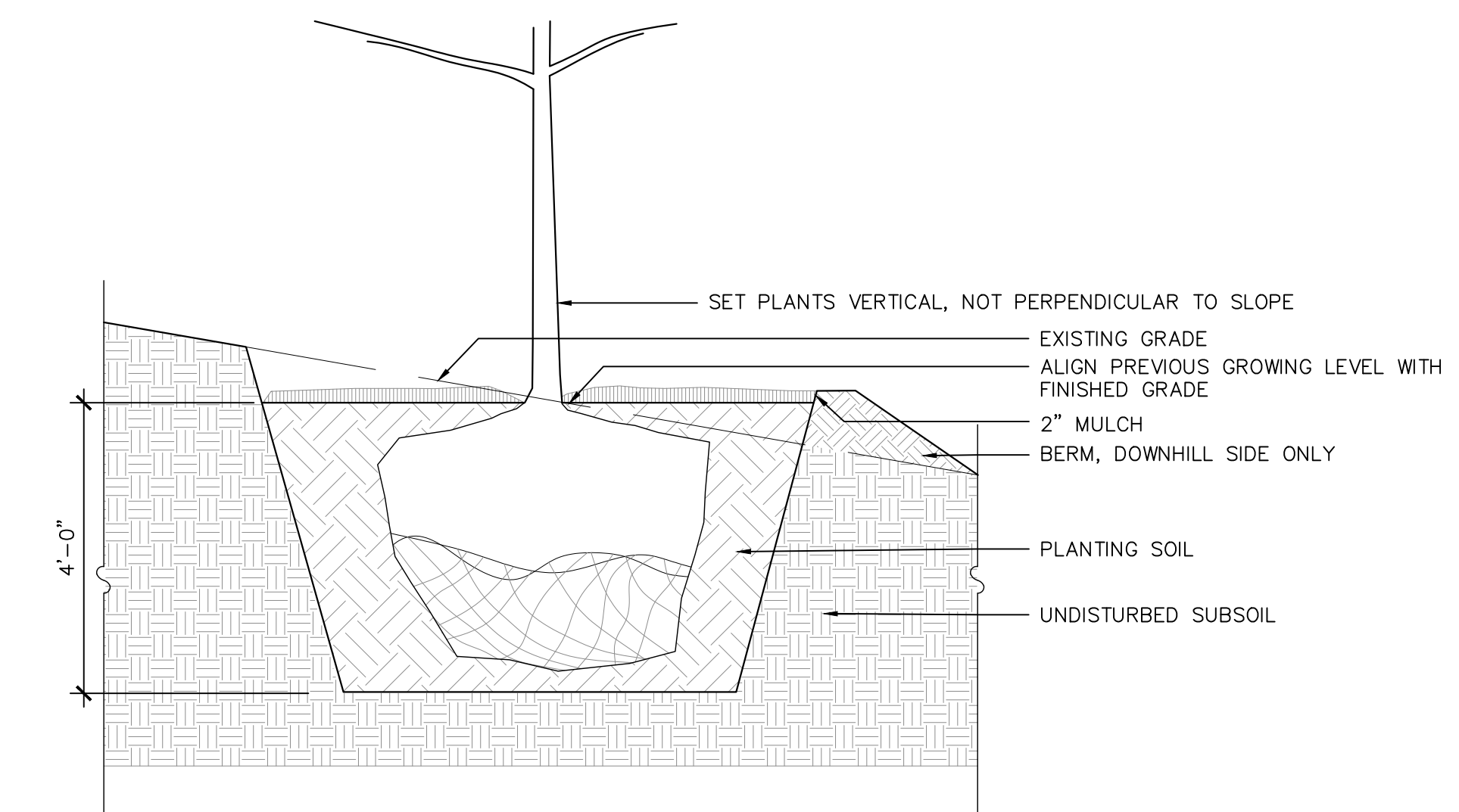

2 TREE PLANTING ON SLOPE, TYP. - SECT
 1/8" = 1'-0"

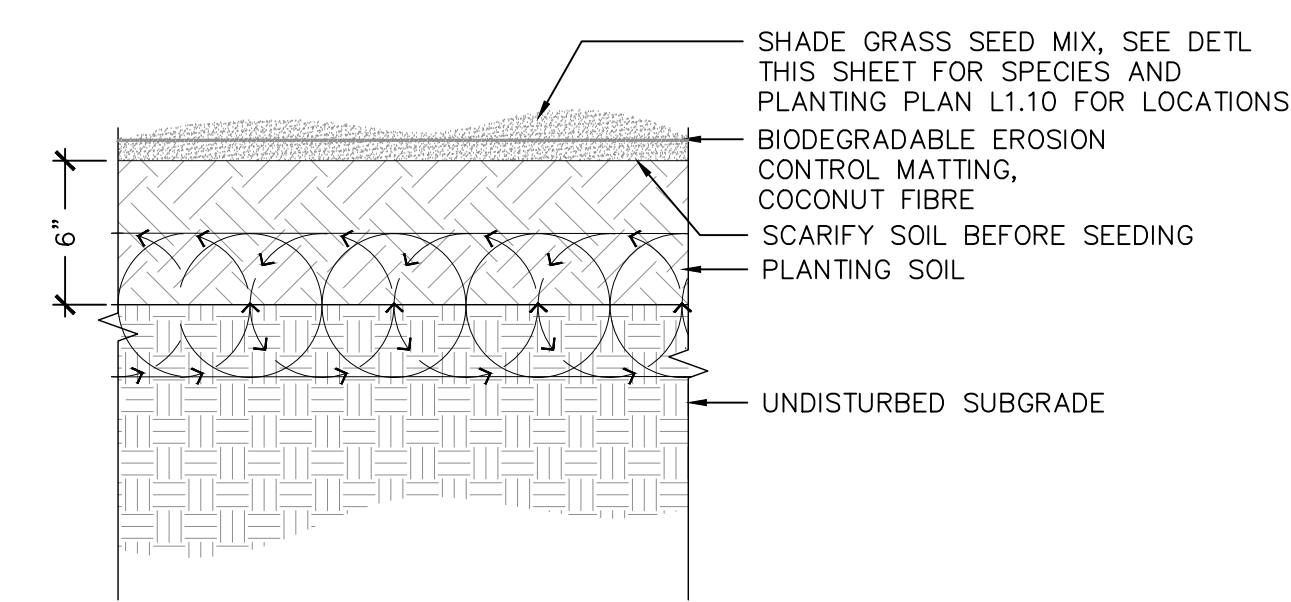

6 SEED PLANTING, TYP.
 1" = 1'

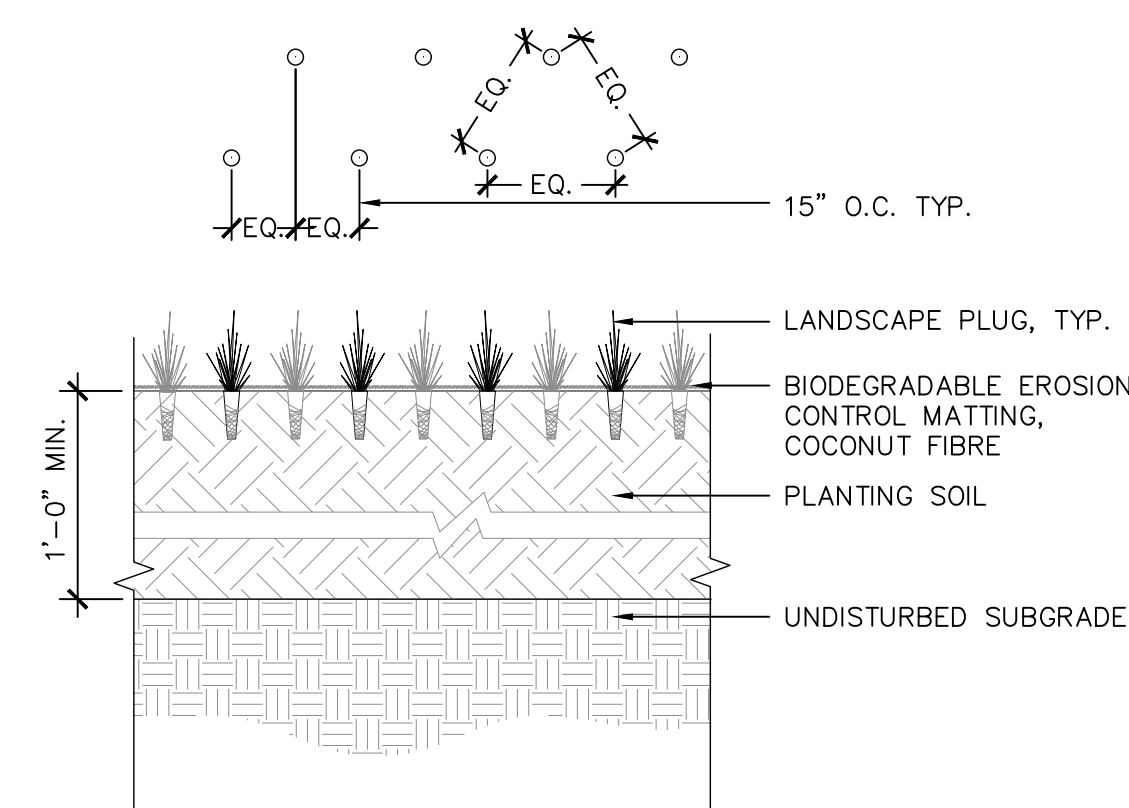

5 LANDSCAPE PLUG PLANTING, TYP.
 1" = 1'

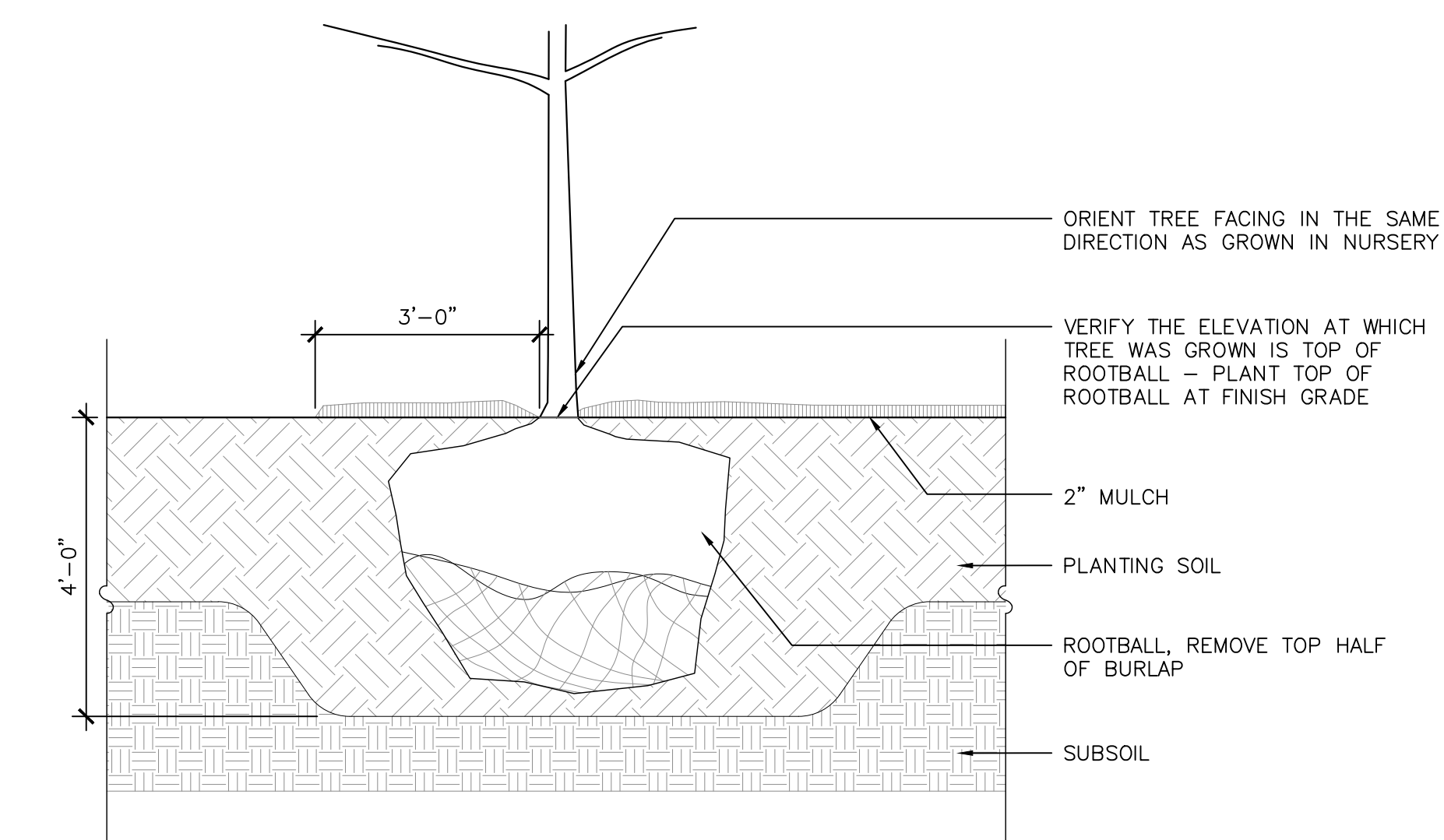

1 TREE PLANTING, TYP.
 1/8" = 1'-0"



LINK LOGISTICS
 1 FAYETTE STREET, SUITE 280
 CONSHOHOCKEN, PA 19428
 PHONE: (610) 708-6222

LANDSCAPE ARCHITECT:
 STUDIO BRYAN HANES
 340 N. 12TH STREET, SUITE 415
 PHILADELPHIA, PA 19107
 PHONE: 215-922-2888

104
 SCHOOLHOUSE
 SOMERSET, NJ

PLANTING
 DETAILS

SCALE: VARIES
 DRAWN BY: BH
 CHECKED BY: BH
 CAD FILE:
 DATE: 11/22/2022
 PROJECT NO.: 2209 (SBH)

| REVISIONS | DATE | DESCRIPTION |
|-----------|------------|-----------------|
| Δ | 11/22/2022 | TOWNSHIP REVIEW |

L1.20

NOT FOR CONSTRUCTION